

2025 Fitting

Perfect Connection, Solid Trust



Contents

Lok Valve

Lok Type Needle valve – Graphite Packing	4
Lok Type Needle valve – NVS1	5
Lok Type Needle valve – NVS1 – 3/4 inch	6
Lok Type Needle valve – NVP1	7
Lok Type Ball Valve – HBV1	8
Lok Type Hex Ball Valve – BV1	9
Lok Type Hex Ball Valve – BV3	10
Lok Type Ball Valve – HBV10, HBV10–NF	11
Lok Type Check Valve	12
LF Coaxial Filter	13

Lok Fitting

Union Fitting, Reducing Union	15
Bulkhead Union, Union Elbow	16
Male Elbow PT, NPT	17
Female Elbow PT, NPT	19
Union Tee, Union Cross	21
Male Connector PT, NPT (Fractional Size)	22
Male Connector PT, NPT (Metric Size)	24
Female Connector PT, NPT (Fractional Size)	26
Male Adapter PT, NPT	28
Female Adapter PT, Female Adapter NPT	30
Cap, Reducer	31
Plug, Thermocouple Male Connector NPT	32
Ferrule Set, Front Ferrule, Back Ferrule	33
Port Connector, Fitting Nut	34

AN Adapter

AN Tube Adapter, AN Female Adapter, AN Union	36
--	----

Pipe Fitting

Vent Protector (VP – Male PT, NPT)	38
Run Tee (RT) PT, NPT	39
Pipe Plug (PP – Male PT, NPT)	40
Male Tee (MT) PT, NPT	41
Male Elbow (ML) PT, NPT	42
Reducing Street Elbow (MFRL) PT, NPT	43
Street Elbow (MFL) PT, NPT	44
Hex Reducing Nipple (HRN – Male PT, NPT)	45
Hex Nipple (HN – Male PT, NPT)	46
Hex Nipple (HNR – Male NPT to ISO Tapered), Hex Long Nipple (HLN)	47
Hex Coupling (HC – Male PT, NPT)	48
Hex Bushing (HB – Male PT, NPT)	49
Tee (FT) PT, NPT	50
Elbow (FL) PT, NPT	51
Cross (FC) PT, NPT	52
Branch Tee (BT) PT, NPT	53
Reducing Adapter (ADR – Male PT, NPT)	54
Adapter (ADR – Male PT, NPT)	55
Adapter (ADRN), Adapter (ADGN)	56

VCR Fitting

Gland (Short Socket Weld), Plug, Male Nut	58
Female Nut, Gland (Male Weld)	59
Male Connector NPT, Tube Fitting Connector, Cap	60

HIFLUX

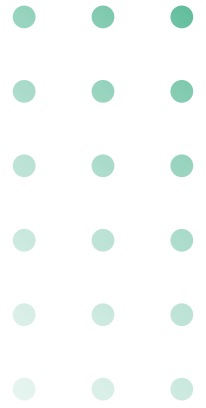

Lok Valve

Perfect Connection, Solid Trust

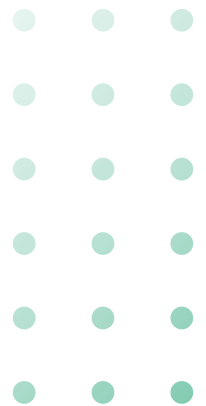

Lok Type Needle valve – Graphite Packing

Graphite Packing

Features

- Pressure up to 6,000psi(413bar) @ 100°F (38°C)
- High Temperatures up to ~ 1,200°F (~ 648°C)
- Graphite packing used.
- Standard 316 stainless steel
- Standard non-rotation stem disc and stem packing below the threads design.
- Valve stem back seating against the bevelled edge of bonnet in fully open position prevents maximum leakage through bonnet when packing fails.



HiFLUX

(Unit:mm)

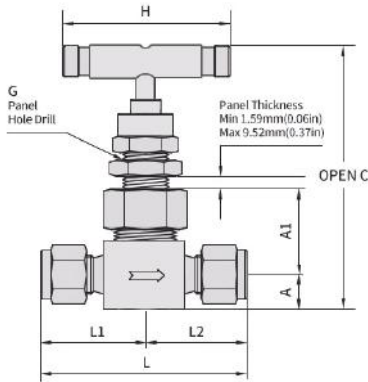

Catalog No	End Connections		Orifice mm	Cv	Dimensions mm(in)						
	Hole	Outlet			L	L1	A1	A	H	G	C
FL-NV1-4T-GF	1/4 Lok		4.0	0,35	61.0	30.5	27.7	9.7	44.4	15.1	77.2
FL-NV2-6T-GF	3/8 Lok		6.4	0,86	71.9	35.8	34.0	12.7	63.5	19.8	94.0

Table of Material

	Component	Material/ASTM Specification
1	Bar Handle	SS316
2	Set screw	Grade B8 TYPE 304/A193
3	Packing Bolt	SS316
4	Cap nut	SS316
5	Bonnet *	SS316
6	Gland	SS316
7	Packing *	Graphite
8	Packing supports	Reinforced PTFE
9	Stem	Hard Chrome-plated SS316
10	Globe disc	TYPE630/A564
11	Panel nut	SS316
12	Union nut	SS316
13	Body *	SS316

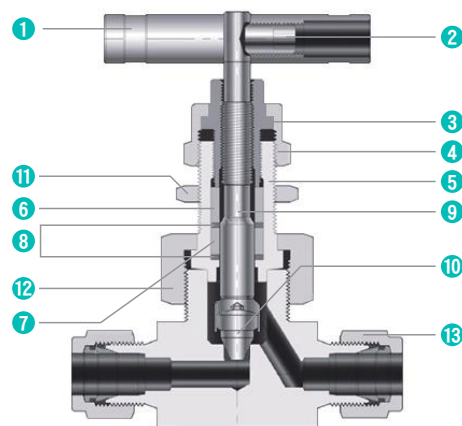

Lok Type Needle valve - NVS1

Integral bonnet

Features

Working pressures up to 5,000psig (345bar) @ 100°F (38°C).

Temperatures up to 315°C (600°F).

Stainless steel 316 material.

Suitable for install on the instrument panel or without panels.

Packing nut allows external packing adjustment to ensure leak-free packing on stem.



HIFLUX

Bonnet-integrated compact needle valve.

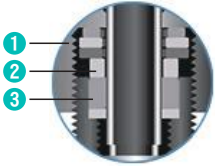

- 1 The packing nut allows for easy adjustment from the outside.
- 2 The packing is fully supported, requiring little to no additional adjustment.
- 3 Enhanced sealing, lower friction, wear compensation, reduced torque.

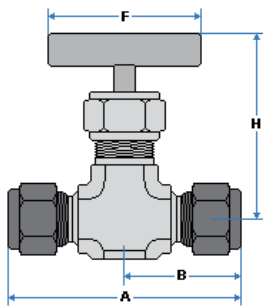

(Unit:mm)

Catalog No	Tube Size	Hole Diameter	Cv	Dimensions			
				A	B	H	F
FL-NVS1-2	1/8"	2.0	0.09	48	24	40.2	44.4
FL-NVS1-4	1/4"	3.2	0.21	62.5	31.2	42.2	44.4
FL-NVS1-6	3/8"	6.4	0.73	78.2	39.1	58.7	63.5
FL-NVS1-8	1/2"	6.4	0.73	83.8	41.9	58.7	63.5

Table of Material

	Component	Material						
		Material Grade / ASTM Specification						
		316SS	Copper	Steel	Alloy			
1	Bar Handle	316SS/A276	-					
	Handle Pin, Set screw	S17400/A564						
2	Round handle	Phenolic with brass insert						
	Set screw	Nickel cadmium-plated steel						
3	Packin nut	316SS/A276	360/B16	12L14/A108	R405/B164			
4	Cap	304SS/A240, A167						
5	Filling Spring	S17700/A693						
6	Filling Cap	316SS/A240, A276, B783						
7	Filling	PTFE						
8	Bottom Cap	316SS/A240			400/B127			
9	Panel nut	316SS	360/B16	316SS				
10	Regulating stem	Chrome-plated 316SS/A276						
11	Vee stem					316SS/A276		R405/B164
12	Soft-seat stem					PCTFE/D1430		
	Stem tip							
13	Body	316SS/A182	377/B283	11L17/A108	400/B564			

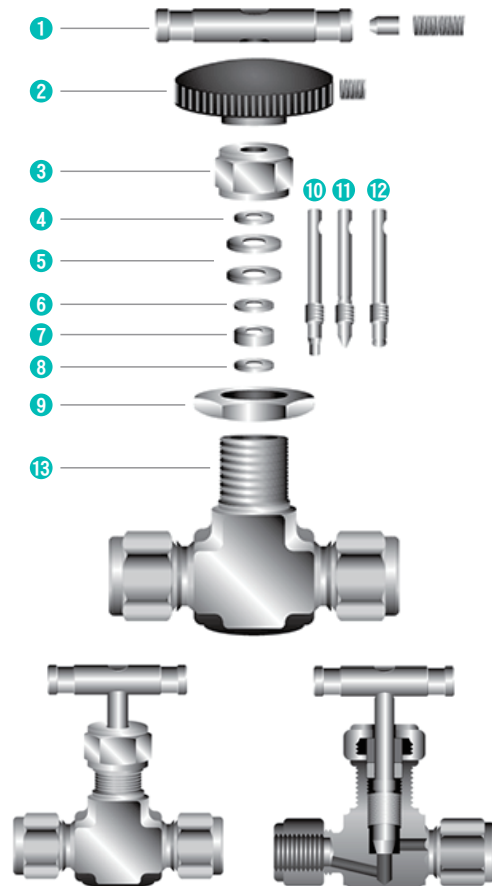

Lok Type Needle valve - NVS1 - 3/4 inch

Integral Bonnet

Features

- Maximum Working Pressure: Up to 5,000 psig (344 bar) at 100°F (38°C)
- Maximum Operating Temperature: -65°F (54°C) to 450°F (232°C)
- Reliable Lok tube fitting ends with NPT and ISO male/female threads
- Metal-to-metal Vee stem suitable for high-temperature applications
- Durable chrome-plated stem threads ensure extended service life
- Panel mountable design
- Externally adjustable packing



FLUXOR

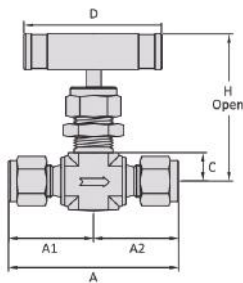

(Unit:mm)

Catalog No	Orifice mm(in)	Cv	End Connection		Dimensions mm(in)					
			Inlet	Outlet	A	A1	A2	C	H	D
FL-NVS1-12	9.5 (0.37)	1.80	3/4" Lok		97 (3.82)	48.5 (1.91)	19 (0.75)	90.6 (3.57)	76.2 (3.0)	

Table of Material

Component	Material / ASTM Specification		
	Stainless Steel 316	Brass	Alloy 400
1 Body	SS316/A182	Brass/B283	-
2 Vee Stem	SS316/A276		Alloy R-405
3 Panel Nut	SS316/A276	Brass/B16	SS316/A276
4 Packing Ring	SS316/A276		Alloy R-405/B164
5 Inner Packing	Standard : PTFE, Optional : PEEK		
6 Out Packing			
7 Packing Gland	SS316/A276	Alloy R-405/B164	
8 Packing Nut	SS316/A276	Brass/B16	Alloy R-405/B164
9 Handle	SS316/A276		
10 Set Screw	SS304/A276		

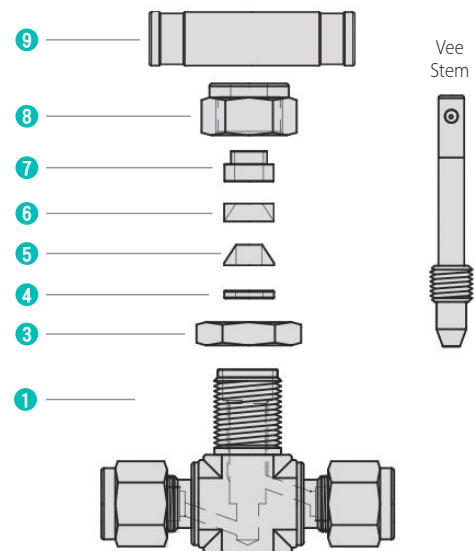

Lok Type Needle valve - NVP1

Integral Bonnet

Features

- Working pressures up to 5,000psig (345bar) @ 100°F (38°C).
- Temperatures up to 315°C (600°F).
- Stainless steel 316 material.
- Suitable for install on the instrument panel or without panels.
- Round handle shown, bar handle available.
- Packing nut allows external packing adjustment to ensure leak-free packing on stem.



Bonnet-integrated compact needle valve.

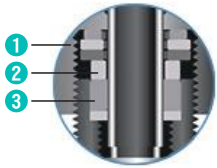

- 1 The packing nut allows for easy adjustment from the outside.
- 2 The packing is fully supported, requiring little to no additional adjustment.
- 3 Enhanced sealing, lower friction, wear compensation, reduced torque.

HIFLUX

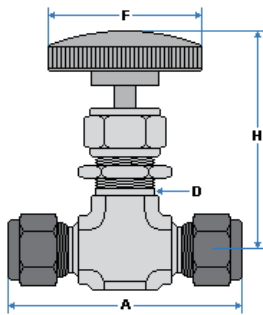

(Unit:mm)

Catalog No	Tube Size	Hole Diameter	Cv	Dimensions			
				A	D(Ø)	H	F
FL-NVP1-2	1/8"	2.0	0.09	49.3	11.9	57.9	35.1
FL-NVP1-4	1/4"	4.4	0.37	57.7	13.5	63.5	35.1
FL-NVP1-6	3/8"	6.4	0.73	65.5	19.8	75.4	47.8
FL-NVP1-8	1/2"	9.5	1.80	96.5	26.2	99.1	47.8

Table of Material

	Component	Material							
		Material Grade / ASTM Specification							
		316SS	Copper	Steel	Alloy				
1	Bar Handle	316SS/A276	-						
	Handle Pin, Set screw	S17400/A564							
2	Round handle	Phenolic with brass insert							
	Set screw	Nickel cadmium-plated steel							
3	Packin nut	316SS/A276	360/B16	12L14/A108	R405/B164				
4	Cap	304SS/A240, A167							
5	Filling Spring	S17700/A693							
6	Filling Cap	316SS/A240, A276, B783							
7	Filling	PTFE							
8	Bottom Cap	316SS/A240			400/B127				
9	Panel nut	316SS	360/B16	316SS					
10	Regulating stem	Chrome-plated 316SS/A276							
11	Vee stem					316SS/A276			R405/B164
12	Soft-seat stem					PCTFE/D1430			
	Stem tip	PCTFE/D1430							
13	Body	316SS/A182	377/B283	11L17/A108	400/B564				

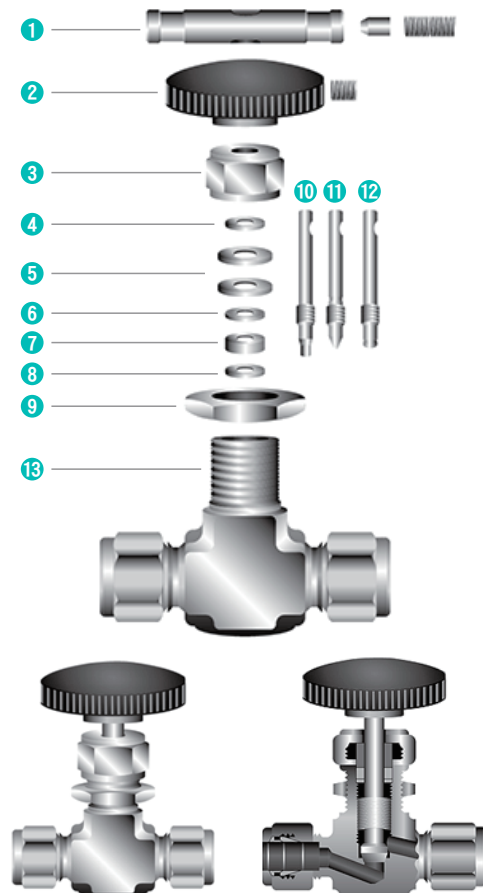

Lok Type Ball Valve - HBV1

Straight type valve with ferrules

Features

- Allows bidirectional flow. one-piece instrumentation ball valves.
- Working pressures up to 5,000psig (345bar) @ 100°F (38°C).
- Temperatures up to -53~148°C (-65~300°F).
- Stainless steel 316 material.
- 1/8" ~ 1" Lok fitting & NPT outlet port.
- ON & OFF Type.
- Panel mounting.
- Low operating torque, compact, maximum-flow design.
- does not require system pressure to seal.
- has virtually no dead space.



HIFLUX

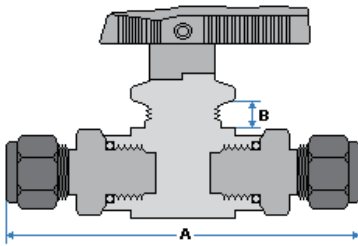

(Unit:mm)

Catalog No	Pressure Rating (psi)	Tube Size	Hole Diameter	Dimensions	
				A	B
FL-HBV1-2	6,000	1/8"	2.4	72	6.4
FL-HBV1-4	6,000	1/4"	4.2	84	6.4
FL-HBV1-6	5,000	3/8"	6.4	96	6.4
FL-HBV1-8	3,000	1/2"	10.3	104	9.7

Table of Material

	Component	Material	
		Brass	Steel
1	Hand wheel	Nylon with inserts	
2	Mounting Bolt	Stainless Steel	
3	Lock Nut	Brass	304, 316SS
4	Adjusting Bolt		
5	Pad	PTFE, PCTFE, PEEK	
6	Top Packing	Brass	304, 316SS
7	Valve Stem		
8	Ball	PTFE, PCTFE	
9	Ball Packing	Brass	304, 316SS
10	Sealing Pad		
11	Connector Body	Brass	304, 316SS
12	Nut		
13	Front Ferrule		
14	Back Ferrule		
15	Body		

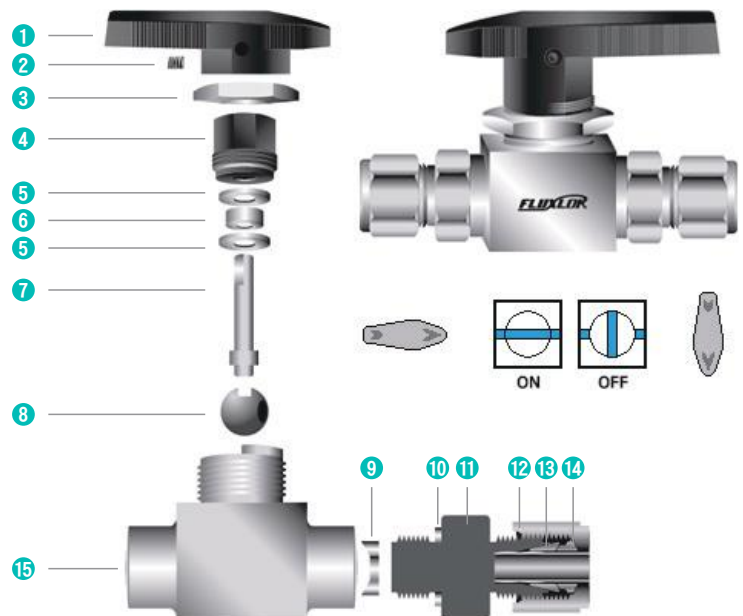

Lok Type Hex Ball Valve - BV1

2way valve with ferrule

Features

- Working pressures up to 2,500psig (172bar).
- Temperatures up to -53~148°C (-65~300°F).
- Stainless steel 316 material.
- is constructed of modified PTFE, reduces potential leak points.
- ON & OFF Type.
- Panel mounting.
- Low operating torque, compact, maximum-flow design.
- does not require system pressure to seal.
- has virtually no dead space.



HiFLUX

Instrumentation ball valve with live-loaded packing and trunnion design.

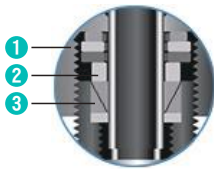

Live load packing

- The packing nut allows for easy adjustment from the outside.
- The packing is fully supported, requiring little to no additional adjustment.
- Enhanced sealing, lower friction, wear compensation, reduced torque.

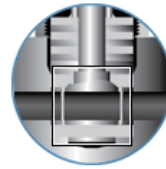

Trunnion-mounted design

- Packing support reduces adjustment.
- Reduced packing volume, less temperature impact.
- Minimized deformation, improved temp performance.

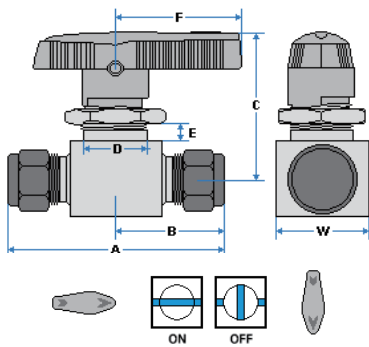

(Unit:mm)

Catalog No	Tube Size	Hole Diameter	Cv	Dimensions						
				A	B	C	D(Ø)	E	F	W
FL-BV1-2	1/8"	2.4	0.15	51	25.5	34.5	14.2	6.4	28.6	14.7
FL-BV1-4	1/4"	4.8	0.9	53.8	26.9	37.3	14	6.4	28.6	15
FL-BV1-6	3/8"	7.1	2.0	70.8	35.4	50	27	10.7	51	28.5
FL-BV1-8	1/2"	10.3	4.6	85	42.5	62	36.5	9	60	38.1

Table of Material

	Component	Material		
		Material Grade / ASTM Specification		
		Copper	Steel	Alloy
1	Hand wheel	Nylon with brass insert		
2	Mounting Bolt	Stainless Steel		
3	Lock Nut			
4	Adjusting Bolt	Brass	304SS, 316SS	Alloy 400
5	Pressure Pad			
6	Bush	PTFE		
7	Gland	Brass	304SS, 316SS	Alloy 400
8	Top Packing	PTFE		
9	Linkage Ball	Brass	304SS, 316SS	Alloy 400
10	Bottom Packing	PTFE		
11	Lined Ring			
12	Lined Plate	Brass	304SS, 316SS	Alloy 400
13	Body			

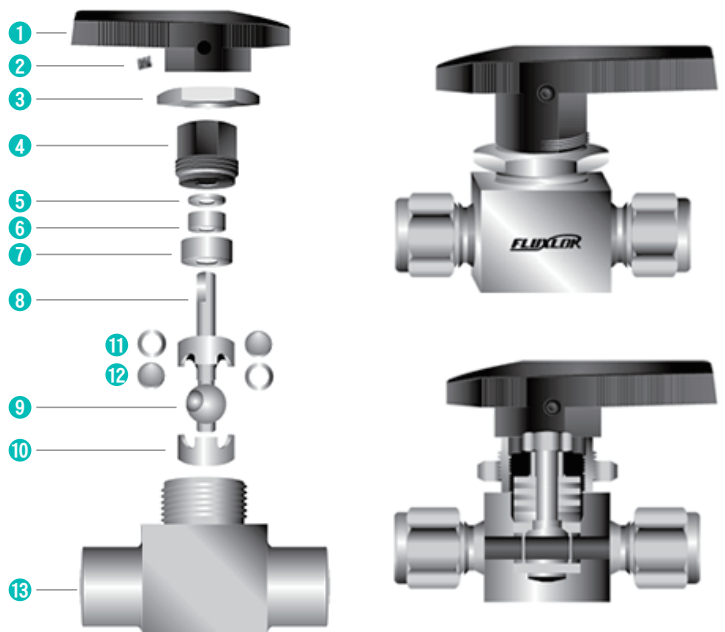

Lok Type Hex Ball Valve – BV3

Butterfly & nylon



Features

- Maximum Operating Pressure : 1000 psig (70 barg) @ 100°F (38°C)
- Operating Temperature Range : -32°F (0°C) to 400(205°C)
- Compact Design with one piece
- Hexagon body
- Stainless Steel 316L
- PTFE seats



(Unit:mm)

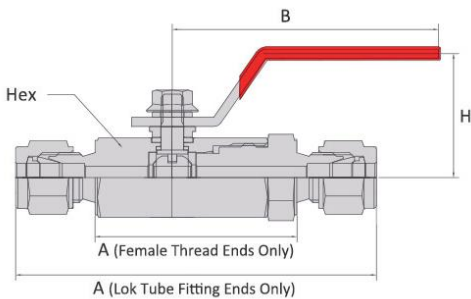

Catalog No	Orifice mm (in)	Cv	End Connections Inlet / Outlet	Dimensions			
				A	H	B	Hex
FL-BV3-4T	5.0 (0.19)	1.25	1/4" Lok	79.4 (3.12)	27.3 (1.07)	58.6 (2.30)	17.46 (11/16)
FL-BV3-4N		1.35	1/4" Female NPT	40 (1.57)			
FL-BV3-4R		1.35	1/4" Female PT	40 (1.57)			
FL-BV3-6T	7.5 (0.30)	2.5	3/8" Lok	89.6 (3.52)	34.6 (1.36)	78.2 (3.07)	22.22 (7/8)
FL-BV3-6N		2.6	3/8" Female NPT	45 (1.77)			
FL-BV3-6R		2.6	3/8" Female PT	45 (1.77)			
FL-BV3-8T	9.0 (0.35)	9.25	1/2" Lok	101 (3.97)	37 (1.45)	78.2 (3.07)	26.98 (1-1/16)
FL-BV3-8N			1/2" Female NPT	54.5 (2.15)			
FL-BV3-8R			1/2" Female PT	54.5 (2.15)			
FL-BV3-12T	12.5 (0.49)	12.65	3/4" Lok	107.5 (4.23)	44 (1.73)	99 (3.89)	31.75 (1-1/4)
FL-BV3-12N			3/4" Female NPT	61 (2.40)			
FL-BV3-12R			3/4" Female PT	61 (2.40)			
FL-BV3-16T	16.0 (0.63)	17.35	1" Lok	132.8 (5.22)	47.2 (1.85)	99 (3.89)	38.1 (1-1/2)
FL-BV3-16N			1" Female NPT	75 (2.95)			
FL-BV3-16R			1" Female PT	75 (2.95)			

Specification

Item	Component	Material / ASTM Specification	
		Stainless Steel	Brass
1	Body	ASTM A276/A479 TYPE316 ASTM A351 CF8M	ASTM B16 or H3250
2	End Connector	ASTM A276 /A479 TYPE316	ASTM B16 or H3250
3	Insert		
4	Stem	ASTM A276 /A479 TYPE316	ASTM A276 /A479 TYPE316
5	Ball		
6	Outer Washer	Stainless Steel	Stainless Steel
7	Lock Nut		
8	Sping Washer	Reinforced PTFE /D1710	Reinforced PTFE /D1710
9	Outer Packing		
10	Inner Packing	FKM(e.g Viton) Standard (NBR)on Request.	
11	Ball Seat		
12	O-Ring		
13	Handle	Stainless Steel Lever Handle PVC Coating	

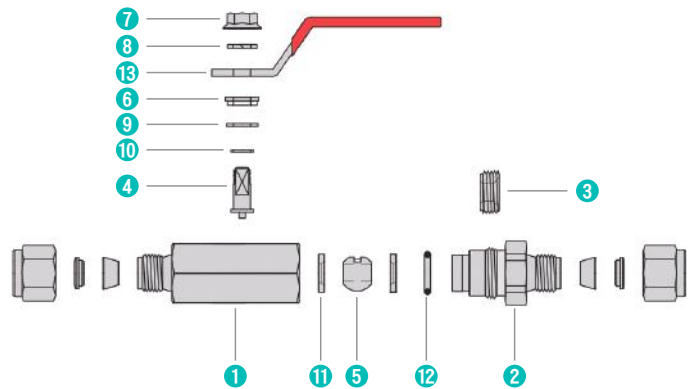

Lok Type Ball Valve - HBV10

Closedown ball valve with ferrules

Features

- Working pressures up to 3,000psi (206bar) Ball valve.
- Live-Loaded packing system double ferrule design.
- Stainless steel 316 material.
- 1/8" ~ 1" Lok fitting & NPT outlet port.
- allows bidirectional flow.
- does not require system pressure to seal.
- Panel mounting
- Low operating torque, compact, maximum-flow design.



HiFLUX

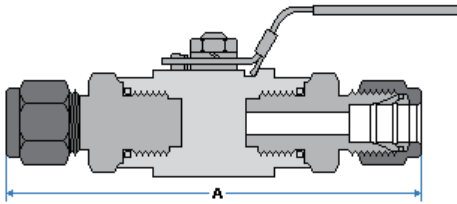

(Unit:mm)

Catalog No.	Pressure Rating (psi)	Tube Size	Hole Diameter	Dimensions	
				A	
FL-HBV10-4	3,000	1/4"	5	90	
FL-HBV10-6	3,000	3/8"	7	90	
FL-HBV10-8	1,500	1/2"	9	95	

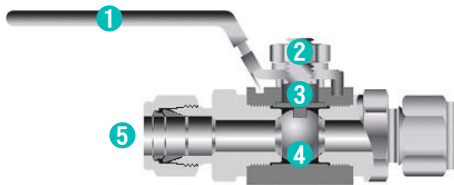

- 1 PVC Coat Color Handle
- 2 Panel Mounting and Locking Device
- 3 Internally Loaded Stem with Shoulder
- 4 Floating Ball Design
- 5 Variety of End Connections

Lok Type Ball Valve - HBV10-NF

Lok Type Ball Valve Female close down

Features

- Working pressures up to 3,000psi (206bar) Ball valve.
- End Connection : NPT Female Port.
- Stainless steel 316 material.
- 1/8" ~ 1" Lok fitting & NPT outlet port.
- allows bidirectional flow.
- Bottom-loaded stem: prevents stem blowout, enhances system safety.
- Panel mounting
- Low operating torque, compact, maximum-flow design.



HiFLUX

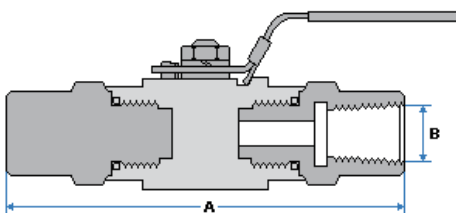

(Unit:mm)

Catalog No.	Pressure Rating (psi)	Hole Diameter	Dimensions	
			A	B
FL-HBV10-NF-4	3,000	5	73	1/4" NPT
FL-HBV10-NF-6	3,000	7	88	3/8" NPT
FL-HBV10-NF-8	1,500	9	102	1/2" NPT

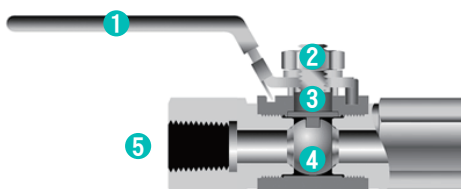

- 1 PVC Coat Color Handle
- 2 Panel Mounting and Locking Device
- 3 Internally Loaded Stem with Shoulder
- 4 Floating Ball Design
- 5 End Connections : NPT Female.

Lok Type Check Valve

CV Series

Features

Working Pressure : 3,000psi (206bar).

Temperatures up to -23~190 ° C (-10~375 ° F)

Stainless steel 316 material.

Adjustable and fixed cracking pressures.

Compact design.

1/8"~1" Size double ferrule design type.

Fitting components provide exceptional dimensional, metallurgical, and mechanical uniformity that allow predictable, repeatable installation.



HiFLUX

(Unit:mm)

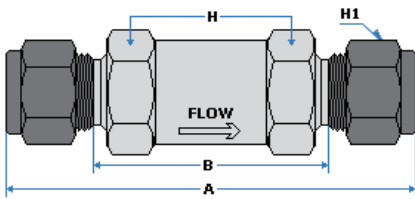

Catalog No	Orifice	Cv	End Connection		Dimensions mm (in)			
			Inlet	Outlet	A	B	H (Hex)	H1 (Hex)
FL-CV1-2	4.8 (0.19)	0.16	1/8" Lok		54.3 (2.14)	28.4 (1.12)	15.87 (5/8)	11.11 (7/16)
FL-CV1-4		0.47	1/4" Lok		59.7 (2.35)	29.5 (1.16)	15.87 (5/8)	14.28 (9/16)
FL-CV2-6	7.1 (0.28)	1.48	3/8" Lok		80.5 (3.17)	47.2 (1.86)	22.22 (7/8)	17.46 (11/16)
FL-CV3-8	10.0 (0.39)	1.70	1/2" Lok		86.9 (3.42)	41.5 (1.63)	22.22 (7/8)	22.22 (7/8)
FL-CV5-12	16.0 (0.62)	5.20	3/4" Lok		109.7 (4.32)	61.0 (2.40)	31.75 (1-1/4)	28.57 (1-1/8)
FL-CV6-16	18.0 (0.70)	8.00	1" Lok		120.4 (4.74)	58.3 (2.30)	34.92 (1-3/8)	38.1 (1-1/2)

Table of Material

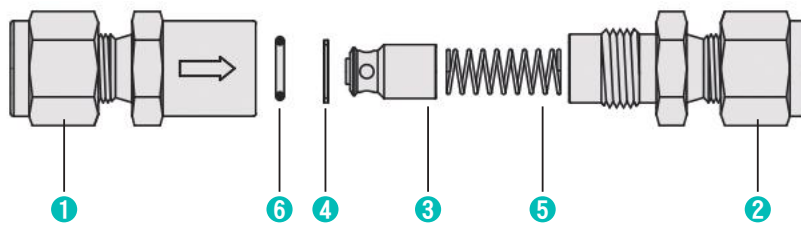

Item	Component	Material / ASTM Specification	
		Stainless Steel	Brass
1	Inlet Body	SS316 / A276, A479	BRASS 360 / B16
2	Outlet Body		
3	Poppet		
4	Washer	SS316 With PTFE Coating	
5	Spring	SS302 / A313	
6	O-Ring	FKM	NBR

LF Coaxial Filter

Replaceable Filter element

Features

Working Pressure : 3,000psi (206bar).

Stainless steel 316 material.

Inline filters are for use where space is limited.

Remove system particulate contaminants.

Replaceable Filter element.

60µ Sintered Type element shown available.

Fitting components provide exceptional dimensional, metallurgical, and mechanical uniformity that allow predictable, repeatable installation.



HIFLUX

(Unit:mm)

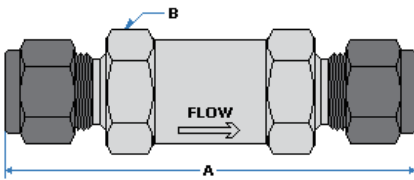

Catalog No	Tube Size	Sintered Filtering Element in2 (mm2)	Dimensions	
			A	B
FL-LF-2	1/8"	0.55 (350)	57.5	14
FL-LF-4	1/4"	1.3 (830)	70	19
FL-LF-6	3/8"	1.3 (830)	81.5	26
FL-LF-8	1/2"	2 (1280)	88.5	26

Table of Material

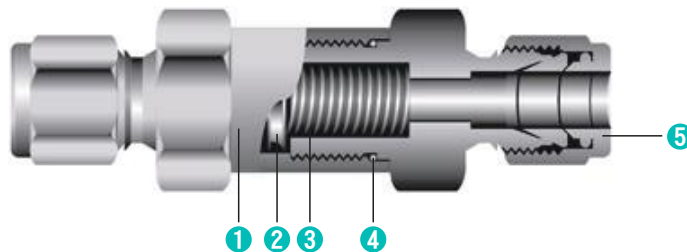

Component		Body Materials	
		Material Grade / ASTM Specification	
		316SS	Copper
1	Body	316SS/A479	Brass/B16
2	Filtering Element	316SS	
3	Spring	302SS	
4	Gasket	316SS	Silver Plated Al/B-209
5	Ferrule Nut	Silver Plated SS/A-276	

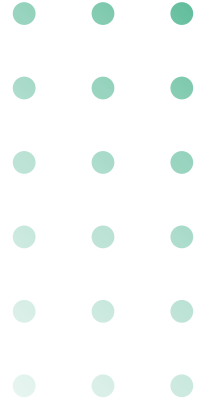

Lok Fitting

Perfect Connection, Solid Trust

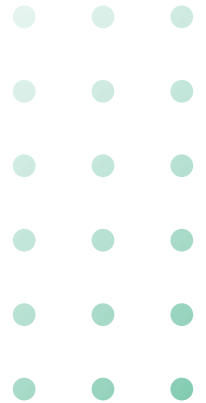

Union Fitting

Connects Fractional Tubes

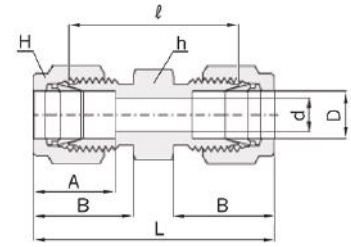

(Unit:mm)

HiFLUX

Catalog No.	Tube O.D. D		d Min.	Width Across Flat				A	A1	l	B1
	in	mm		h		H					
				in	mm	in	mm				
FL6-1	1/16	1.58	1.27	5/16	7.93	5/16	7.93	8.63	10.92	17.50	25.15
FL6-2	1/8	3.17	2.28	7/16	11.11	7/16	11.11	12.70	15.24	22.35	35.56
FL6-4	1/4	6.35	4.82	1/2	12.70	9/16	14.28	15.24	17.78	26.16	40.89
FL6-6	3/8	9.52	7.11	5/8	15.87	11/16	17.46	16.76	19.30	30.22	44.95
FL6-8	1/2	12.70	10.41	13/16	20.63	7/8	22.22	22.86	21.84	30.98	51.30
FL6-12	3/4	19.05	15.74	1-1/16	26.98	1-1/8	28.57	24.38	21.84	33.27	53.59
FL6-16	1	25.40	22.35	1-3/8	34.92	1-1/2	38.10	31.24	26.41	40.38	64.77

Reducing Union

Connects Fractional Tubes

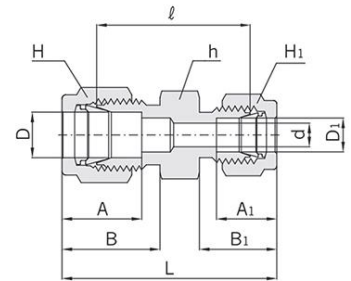
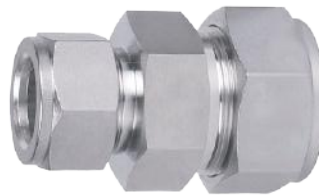

(Unit:mm)

HiFLUX

Catalog No.	Tube O.D. (D)				d Min.	Width Across Flat						A	A1	B	B1	l	L
	D		D1			h		H		H1							
	in	mm	in	mm		in	mm	in	mm	in	mm						
FLRU-0402	1/4"	6.35	1/8"	3.17	2.28	1/2"	12.70	9/16"	14.28	7/16"	11.11	15.24	12.70	17.78	15.24	24.63	38.60
FLRU-0604	3/8"	9.52	1/4"	6.35	4.82	5/8"	15.87	11/16"	17.46	9/16"	14.28	16.76	15.24	19.30	17.78	28.44	43.18
FLRU-0806	1/2"	12.70	3/8"	9.52	7.11	13/16"	20.63	7/8"	22.22	11/16"	17.46	22.86	16.76	21.84	19.30	30.98	48.51
FLRU-1208	3/4"	19.05	1/2"	12.70	10.41	1-1/16"	26.98	1-1/8"	28.57	7/8"	22.22	24.38	22.86	21.84	21.84	33.27	53.59
FLRU-1612	1"	25.40	3/4"	19.05	15.74	1-3/8"	34.92	1-1/2"	38.10	1-1/8"	28.57	31.24	24.38	26.41	21.84	40.38	62.73

Bulkhead Union

Connects Fractional Tubes

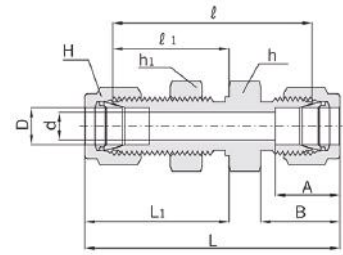

(Unit:mm)

HIFLUX

Catalog No.	Tube O.D. D		d Min.	Width Across Flat				A	B	ℓ	ℓ 1	L	L1	Panel Hole Drill Size	Panel Max Thickness
	in	mm		h, h1		H									
				in	mm	in	mm								
FLBU-03	3/16"	4.76	3.04	9/16"	14.28	1/2"	12.70	13.71	16.00	40.38	25.40	53.59	32.00	9.92	12.70
FLBU-04	1/4"	6.35	4.82	5/8"	15.87	9/16"	14.28	15.24	17.78	42.92	26.16	57.65	33.52	11.50	10.16
FLBU-06	3/8"	9.52	7.11	3/4"	19.05	11/16"	17.46	16.76	19.30	47.49	29.46	62.23	36.83	14.68	11.17
FLBU-08	1/2"	12.70	10.41	15/16"	23.81	7/8"	22.22	22.86	21.84	50.80	31.75	71.12	41.91	19.44	12.70
FLBU-12	3/4"	19.05	15.74	1-3/16"	30.16	1-1/8"	28.57	24.38	21.84	58.67	37.33	78.99	47.49	25.79	16.76
FLBU-16	1"	25.40	22.35	1-5/8"	41.27	1-1/2"	38.10	31.24	26.41	71.37	45.21	95.75	57.40	33.73	19.05

Union Elbow

Connects Fractional Tubes

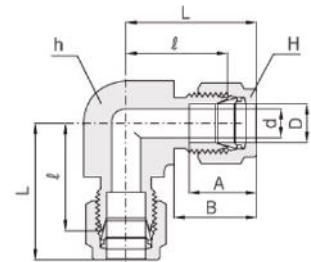

(Unit:mm)

HIFLUX

Catalog No.	Tube O.D. D		d Min.	Width Across Flat				A	B	ℓ	L
	in	mm		h		H					
				in	mm	in	mm				
FL9-2	1/8	3.17	2.28	7/16	11.11	7/16	11.11	12.70	15.24	15.74	22.35
FL9-4	1/4	6.35	4.82	1/2	12.70	9/16	14.28	15.24	17.78	19.55	26.92
FL9-6	3/8	9.52	7.11	5/8	15.87	11/16	17.46	16.76	19.30	23.11	30.48
FL9-8	1/2	12.70	10.41	13/16	20.63	7/8	22.22	22.86	21.84	25.90	36.06
FL9-12	3/4	19.05	15.74	1-1/16	26.98	1-1/8	28.57	24.38	21.84	29.71	39.87
FL9-16	1	25.40	22.35	1-3/8	34.92	1-1/2	38.10	31.24	26.41	36.83	49.02

Male Elbow PT

Connects Fractional Tube To Female PT Thread

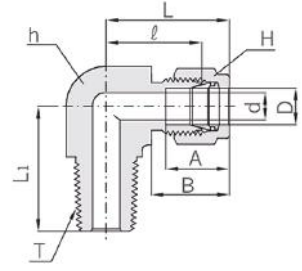

(Unit:mm)

Catalog No.	Tube O.D. D		T* (PT)	d Min.	Width Across Flat				A	B	φ	L	L1
	in	mm			h		H						
					in	mm	in	mm					
FLME-0101R	1/16"	1.58	1/16"	1.27	7/16"	11.11	5/16"	7.93	8.63	10.92	15.24	19.05	17.78
FLME-0202R	1/8"	3.17	1/8"	2.28	7/16"	11.11	7/16"	11.11	12.70	15.24	17.02	23.62	17.78
FLME-0204R	1/8"	3.17	1/4"	2.28	1/2"	12.70	7/16"	11.11	12.70	15.24	18.03	24.64	22.80
FLME-0402R	1/4"	6.35	1/8"	4.82	1/2"	12.70	9/16"	14.28	15.24	17.78	19.10	26.47	19.10
FLME-0404R	1/4"	6.35	1/4"	4.82	1/2"	12.70	9/16"	14.28	15.24	17.78	19.81	27.18	23.36
FLME-0406R	1/4"	6.35	3/8"	4.82	11/16"	17.46	9/16"	14.28	15.24	17.78	22.35	29.71	28.40
FLME-0408R	1/4"	6.35	1/2"	4.82	13/16"	20.63	9/16"	14.28	15.24	17.78	24.60	31.97	33.00
FLME-0602R	3/8"	9.52	1/8"	4.82	5/8"	15.87	11/16"	17.46	16.76	19.30	23.11	30.48	20.60
FLME-0604R	3/8"	9.52	1/4"	7.11	5/8"	15.87	11/16"	17.46	16.76	19.30	23.11	30.48	25.40
FLME-0606R	3/8"	9.52	3/8"	7.11	11/16"	17.46	11/16"	17.46	16.76	19.30	23.87	31.24	26.20
FLME-0608R	3/8"	9.52	1/2"	7.11	13/16"	20.63	11/16"	17.46	16.76	19.30	23.80	31.42	33.02
FLME-0804R	1/2"	12.70	1/4"	7.11	13/16"	20.63	7/8"	22.22	22.86	21.84	25.90	36.06	28.30
FLME-0806R	1/2"	12.70	3/8"	9.65	13/16"	20.63	7/8"	22.22	22.86	21.84	25.90	36.06	28.30
FLME-0808R	1/2"	12.70	1/2"	10.41	13/16"	20.63	7/8"	22.22	22.86	21.84	25.90	36.06	33.02
FLME-1208R	3/4"	19.05	1/2"	11.93	1-1/16"	26.98	1-1/18"	28.57	24.38	21.84	29.71	39.87	36.83
FLME-1212R	3/4"	19.05	3/4"	15.74	1-1/16"	26.98	1-1/18"	28.57	24.38	21.84	29.71	39.87	36.83
FLME-1612R	1"	25.40	3/4"	15.74	1-3/8"	34.92	1-1/2"	38.10	31.24	26.41	36.83	49.02	42.20
FLME-1616R	1"	25.40	1"	22.35	1-3/8"	34.92	1-1/2"	38.10	31.24	26.41	36.83	49.02	46.50

Male Elbow NPT

Connects Fractional Tube To Female PT Thread

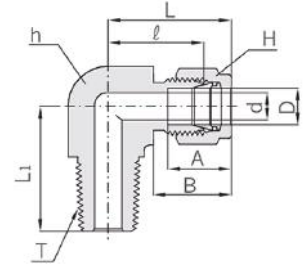

(Unit:mm)

Catalog No.	Tube O.D. D		T* (NPT)	d Min.	Width Across Flat				A	B	φ	L	L1
	in	mm			h		H						
					in	mm	in	mm					
FLME-0101N	1/16"	1.58	1/16"	1.27	7/16"	11.11	5/16"	7.93	8.63	10.92	15.24	19.05	17.78
FLME-0202N	1/8"	3.17	1/8"	2.28	7/16"	11.11	7/16"	11.11	12.70	15.24	17.02	23.62	17.78
FLME-0204N	1/8"	3.17	1/4"	2.28	1/2"	12.70	7/16"	11.11	12.70	15.24	18.03	24.64	22.80
FLME-0402N	1/4"	6.35	1/8"	4.82	1/2"	12.70	9/16"	14.28	15.24	17.78	19.10	26.47	19.10
FLME-0404N	1/4"	6.35	1/4"	4.82	1/2"	12.70	9/16"	14.28	15.24	17.78	19.81	27.18	23.36
FLME-0406N	1/4"	6.35	3/8"	4.82	11/16"	17.46	9/16"	14.28	15.24	17.78	22.35	29.71	28.40
FLME-0408N	1/4"	6.35	1/2"	4.82	13/16"	20.63	9/16"	14.28	15.24	17.78	24.60	31.97	33.00
FLME-0602N	3/8"	9.52	1/8"	4.82	5/8"	15.87	11/16"	17.46	16.76	19.30	23.11	30.48	20.60
FLME-0604N	3/8"	9.52	1/4"	7.11	5/8"	15.87	11/16"	17.46	16.76	19.30	23.11	30.48	25.40
FLME-0606N	3/8"	9.52	3/8"	7.11	11/16"	17.46	11/16"	17.46	16.76	19.30	23.87	31.24	26.20
FLME-0608N	3/8"	9.52	1/2"	7.11	13/16"	20.63	11/16"	17.46	16.76	19.30	23.80	31.42	33.02
FLME-0804N	1/2"	12.70	1/4"	7.11	13/16"	20.63	7/8"	22.22	22.86	21.84	25.90	36.06	28.30
FLME-0806N	1/2"	12.70	3/8"	9.65	13/16"	20.63	7/8"	22.22	22.86	21.84	25.90	36.06	28.30
FLME-0808N	1/2"	12.70	1/2"	10.41	13/16"	20.63	7/8"	22.22	22.86	21.84	25.90	36.06	33.02
FLME-1208N	3/4"	19.05	1/2"	11.93	1-1/16"	26.98	1-1/18"	28.57	24.38	21.84	29.71	39.87	36.83
FLME-1212N	3/4"	19.05	3/4"	15.74	1-1/16"	26.98	1-1/18"	28.57	24.38	21.84	29.71	39.87	36.83
FLME-1612N	1"	25.40	3/4"	15.74	1-3/8"	34.92	1-1/2"	38.10	31.24	26.41	36.83	49.02	42.20
FLME-1616N	1"	25.40	1"	22.35	1-3/8"	34.92	1-1/2"	38.10	31.24	26.41	36.83	49.02	46.50

Female Elbow PT

Connects Fractional Tube To Male PT Thread

HIFLUX

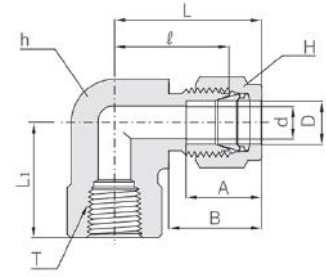

(Unit:mm)

Catalog No.	Tube O.D. D		T* (PT)	d Min.	Width Across Flat				A	B	φ	L	L1
	in	mm			h		H						
					in	mm	in	mm					
FLFE-0202R	1/8"	3.17	1/8"	2.28	9/16"	14.28	7/16"	11.11	12.70	15.24	18.03	24.63	19.05
FLFE-0204R	1/8"	3.17	1/4"	2.28	11/16"	17.46	7/16"	11.11	12.70	15.24	20.82	27.43	22.35
FLFE-0402R	1/4"	6.35	1/8"	4.82	9/16"	14.28	9/16"	14.28	15.24	17.78	19.55	26.92	19.05
FLFE-0404R	1/4"	6.35	1/4"	4.82	11/16"	17.46	9/16"	14.28	15.24	17.78	22.35	29.71	22.35
FLFE-0406R	1/4"	6.35	3/8"	4.82	13/16"	20.63	9/16"	14.28	15.24	17.78	24.38	31.75	22.35
FLFE-0602R	3/8"	9.52	1/8"	7.11	5/8"	15.87	11/16"	17.46	16.76	19.30	23.11	30.48	19.05
FLFE-0604R	3/8"	9.52	1/4"	7.11	11/16"	17.46	11/16"	17.46	16.76	19.30	23.87	31.24	22.35
FLFE-0606R	3/8"	9.52	3/8"	7.11	13/16"	20.63	11/16"	17.46	16.76	19.30	25.90	33.27	22.35
FLFE-0804R	1/2"	12.70	1/4"	10.41	13/16"	20.63	7/8"	22.22	22.86	21.84	25.90	36.06	22.35
FLFE-0806R	1/2"	12.70	3/8"	10.41	13/16"	20.63	7/8"	22.22	22.86	21.84	25.90	36.06	22.35
FLFE-0806R	1/2"	12.70	3/8"	10.41	13/16"	20.63	7/8"	22.22	22.86	21.84	25.90	36.06	22.35
FLFE-0808R	1/2"	12.70	1/2"	10.41	1"	25.40	7/8"	22.22	22.86	21.84	28.70	38.86	28.44
FLFE-1208R	3/4"	19.05	1/2"	15.74	1-1/16"	26.98	1-1/8"	28.57	24.38	21.84	29.71	39.87	28.44
FLFE-1212R	3/4"	19.05	3/4"	15.74	1-3/8"	34.92	1-1/8"	28.57	24.38	21.84	34.54	44.70	31.75
FLFE-1612R	1"	25.40	3/4"	22.35	1-3/8"	34.92	1-1/2"	38.10	31.24	26.41	36.83	49.02	31.75
FLFE-1616R	1"	25.40	1"	22.35	1-11/16"	42.86	1-1/2"	38.10	31.24	26.41	41.40	53.59	38.10

Female Elbow NPT

Connects Fractional Tube To Male NPT Thread

HiFLUX

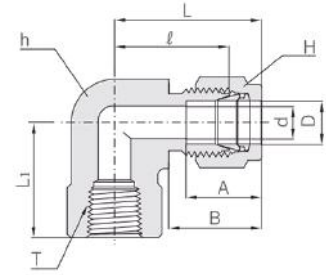

(Unit:mm)

Catalog No.	Tube O.D. D		T* (NPT)	d Min.	Width Across Flat				A	B	φ	L	L1
	in	mm			h		H						
					in	mm	in	mm					
FLFE-0202N	1/8"	3.17	1/8"	2.28	9/16"	14.28	7/16"	11.11	12.70	15.24	18.03	24.63	19.05
FLFE-0204N	1/8"	3.17	1/4"	2.28	11/16"	17.46	7/16"	11.11	12.70	15.24	20.82	27.43	22.35
FLFE-0402N	1/4"	6.35	1/8"	4.82	9/16"	14.28	9/16"	14.28	15.24	17.78	19.55	26.92	19.05
FLFE-0404N	1/4"	6.35	1/4"	4.82	11/16"	17.46	9/16"	14.28	15.24	17.78	22.35	29.71	22.35
FLFE-0406N	1/4"	6.35	3/8"	4.82	13/16"	20.63	9/16"	14.28	15.24	17.78	24.38	31.75	22.35
FLFE-0602N	3/8"	9.52	1/8"	7.11	5/8"	15.87	11/16"	17.46	16.76	19.30	23.11	30.48	19.05
FLFE-0604N	3/8"	9.52	1/4"	7.11	11/16"	17.46	11/16"	17.46	16.76	19.30	23.87	31.24	22.35
FLFE-0606N	3/8"	9.52	3/8"	7.11	13/16"	20.63	11/16"	17.46	16.76	19.30	25.90	33.27	22.35
FLFE-0804N	1/2"	12.70	1/4"	10.41	13/16"	20.63	7/8"	22.22	22.86	21.84	25.90	36.06	22.35
FLFE-0806N	1/2"	12.70	3/8"	10.41	13/16"	20.63	7/8"	22.22	22.86	21.84	25.90	36.06	22.35
FLFE-0806N	1/2"	12.70	3/8"	10.41	13/16"	20.63	7/8"	22.22	22.86	21.84	25.90	36.06	22.35
FLFE-0808N	1/2"	12.70	1/2"	10.41	1"	25.40	7/8"	22.22	22.86	21.84	28.70	38.86	28.44
FLFE-1208N	3/4"	19.05	1/2"	15.74	1-1/16"	26.98	1-1/8"	28.57	24.38	21.84	29.71	39.87	28.44
FLFE-1212N	3/4"	19.05	3/4"	15.74	1-3/8"	34.92	1-1/8"	28.57	24.38	21.84	34.54	44.70	31.75
FLFE-1612N	1"	25.40	3/4"	22.35	1-3/8"	34.92	1-1/2"	38.10	31.24	26.41	36.83	49.02	31.75
FLFE-1616N	1"	25.40	1"	22.35	1-11/16"	42.86	1-1/2"	38.10	31.24	26.41	41.40	53.59	38.10

Union Tee

Connects Fractional Tubes

HiFLUX

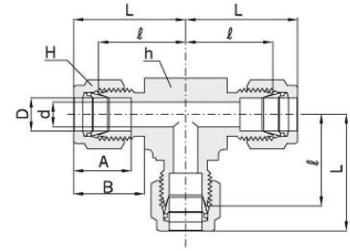

(Unit:mm)

Catalog No.	Tube O.D. D		d Min.	Width Across Flat				A	B	φ	L
	in	mm		h		H					
				in	mm	in	mm				
FL3-1	1/16	1.58	1.27	7/16	11.11	5/16	7.93	8.63	10.92	14.00	17.88
FL3-2	1/8	3.17	2.28	7/16	11.11	7/16	11.11	12.70	15.24	15.74	22.35
FL3-4	1/4	6.35	4.82	1/2	12.70	9/16	14.28	15.24	17.78	19.55	26.92
FL3-6	3/8	9.52	7.11	5/8	15.87	11/16	17.46	16.76	19.30	23.11	30.48
FL3-8	1/2	12.70	10.41	13/16	20.63	7/8	22.22	22.86	21.84	25.90	36.06
FL3-12	3/4	19.05	15.74	1-1/16	26.98	1-1/8	28.57	24.38	21.84	29.71	39.87
FL3-16	1	25.40	22.35	1-3/8	34.92	1-1/2	38.10	31.24	26.41	36.83	49.02

Union Cross

Connects Fractional Tubes

HiFLUX

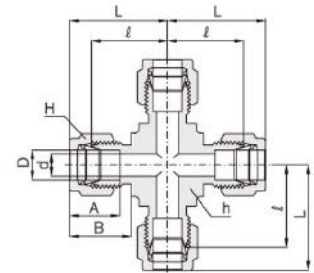

(Unit:mm)

Catalog No.	Tube O.D. D		d Min.	Width Across Flat				A	B	φ	L
	in	mm		h		H					
				in	mm	in	mm				
FL4-2	1/8	3.17	2.28	7/16	11.11	7/16	11.11	12.70	15.24	15.74	22.35
FL4-4	1/4	6.35	4.82	1/2	12.70	9/16	14.28	15.24	17.78	19.55	26.92
FL4-6	3/8	9.52	7.11	5/8	15.87	11/16	17.46	16.76	19.30	23.11	30.48
FL4-8	1/2	12.70	10.41	13/16	20.63	7/8	22.22	22.86	21.84	25.90	36.06
FL4-12	3/4	19.05	15.74	1-1/16	26.98	1-1/8	28.57	24.38	21.84	29.71	39.87
FL4-16	1	25.40	22.35	1-3/8	34.92	1-1/2	38.10	31.24	26.41	36.83	49.02

Male Connector PT (Fractional Size)

Connects Fractional Tube To Female PT Thread

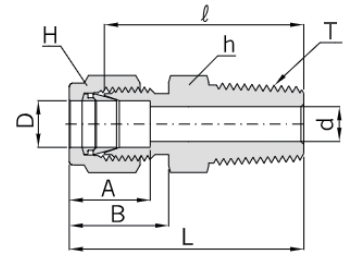

HIFLUX

(Unit:mm)

Catalog No.	Tube O.D. D		T* PT Size	d+ Min.	Width Across Flat(in.)				A	B	l	L
	in	mm			h		H					
					in	mm	in	mm				
FLMC-0202R	1/8	3.17	1/8	2.28	7/16	11.11	7/16	11.11	12.70	15.24	23.87	30.48
FLMC-0204R	1/8	3.17	1/4	2.28	9/16	14.28	7/16	11.11	12.70	15.24	28.95	35.56
FLMC-0206R	1/8	3.17	3/8	2.28	11/16	17.46	7/16	11.11	12.70	15.24	29.21	35.81
FLMC-0208R	1/8	3.17	1/2	2.28	7/8	22.22	7/16	11.11	12.70	15.24	35.56	42.16
FLMC-0402R	1/4	6.35	1/8	4.82	1/2	12.70	9/16	14.28	15.24	17.78	25.40	32.76
FLMC-0404R	1/4	6.35	1/4	4.82	9/16	14.28	9/16	14.28	15.24	17.78	30.48	37.84
FLMC-0406R	1/4	6.35	3/8	4.82	11/16	17.46	9/16	14.28	15.24	17.78	30.98	38.35
FLMC-0408R	1/4	6.35	1/2	4.82	7/8	22.22	9/16	14.28	15.24	17.78	37.33	44.70
FLMC-0412R	1/4	6.35	3/4	4.82	1-1/16	26.98	9/16	14.28	15.24	17.78	38.86	46.22
FLMC-0602R	3/8	9.52	1/8	4.82	5/8	15.87	11/16	17.46	16.76	19.30	27.94	35.30
FLMC-0604R	3/8	9.52	1/4	7.11	5/8	15.87	11/16	17.46	16.76	19.30	32.51	39.87
FLMC-0606R	3/8	9.52	3/8	7.11	11/16	17.46	11/16	17.46	16.76	19.30	32.51	39.87
FLMC-0608R	3/8	9.52	1/2	7.11	7/8	22.22	11/16	17.46	16.76	19.30	38.86	46.22
FLMC-0612R	3/8	9.52	3/4	7.11	1-1/16	26.98	11/16	17.46	16.76	19.30	40.38	47.75
FLMC-0802R	1/2	12.70	1/8	4.82	13/16	20.63	7/8	22.22	22.86	21.84	28.70	38.86
FLMC-0804R	1/2	12.70	1/4	7.11	13/16	20.63	7/8	22.22	22.86	21.84	33.27	43.43
FLMC-0806R	1/2	12.70	3/8	9.65	13/16	20.63	7/8	22.22	22.86	21.84	33.27	43.43
FLMC-0808R	1/2	12.70	1/2	10.41	7/8	22.22	7/8	22.22	22.86	21.84	38.86	49.02
FLMC-0812R	1/2	12.70	3/4	10.41	1-1/16	26.98	7/8	22.22	22.86	21.84	40.38	50.54
FLMC-0816R	1/2	12.70	1	10.41	1-3/8	34.92	7/8	22.22	22.86	21.84	46.99	57.15
FLMC-1208R	3/4	19.05	1/2	11.93	1-1/16	26.98	1-1/8	28.57	24.38	21.84	40.38	50.54
FLMC-1212R	3/4	19.05	3/4	15.74	1-1/16	26.98	1-1/8	28.57	24.38	21.84	40.38	50.54
FLMC-1216R	3/4	19.05	1	15.74	1-3/8	34.92	1-1/8	28.57	24.38	21.84	46.99	57.15
FLMC-1608R	1	25.40	1/2	11.93	1-3/8	34.92	1-1/2	38.10	31.24	26.41	45.21	57.40
FLMC-1612R	1	25.40	3/4	15.74	1-3/8	34.92	1-1/2	38.10	31.24	26.41	45.21	57.40
FLMC-1616R	1	25.40	1	22.35	1-3/8	34.92	1-1/2	38.10	31.24	26.41	50.03	62.23

Male Connector NPT (Fractional Size)

Connects Fractional Tube To Female NPT Thread

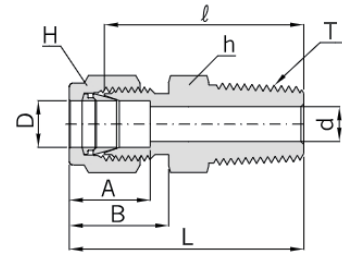

HiFLUX

(Unit:mm)

Catalog No.	Tube O.D. D		T* NPT Size	d+ Min.	Width Across Flat(in.)				A	B	l	L
	in	mm			h		H					
					in	mm	in	mm				
FLMC-0202N	1/8	3.17	1/8	2.28	7/16	11.11	7/16	11.11	12.70	15.24	23.87	30.48
FLMC-0204N	1/8	3.17	1/4	2.28	9/16	14.28	7/16	11.11	12.70	15.24	28.95	35.56
FLMC-0206N	1/8	3.17	3/8	2.28	11/16	17.46	7/16	11.11	12.70	15.24	29.21	35.81
FLMC-0208N	1/8	3.17	1/2	2.28	7/8	22.22	7/16	11.11	12.70	15.24	35.56	42.16
FLMC-0402N	1/4	6.35	1/8	4.82	1/2	12.70	9/16	14.28	15.24	17.78	25.40	32.76
FLMC-0404N	1/4	6.35	1/4	4.82	9/16	14.28	9/16	14.28	15.24	17.78	30.48	37.84
FLMC-0406N	1/4	6.35	3/8	4.82	11/16	17.46	9/16	14.28	15.24	17.78	30.98	38.35
FLMC-0408N	1/4	6.35	1/2	4.82	7/8	22.22	9/16	14.28	15.24	17.78	37.33	44.70
FLMC-0412N	1/4	6.35	3/4	4.82	1-1/16	26.98	9/16	14.28	15.24	17.78	38.86	46.22
FLMC-0602N	3/8	9.52	1/8	4.82	5/8	15.87	11/16	17.46	16.76	19.30	27.94	35.30
FLMC-0604N	3/8	9.52	1/4	7.11	5/8	15.87	11/16	17.46	16.76	19.30	32.51	39.87
FLMC-0606N	3/8	9.52	3/8	7.11	11/16	17.46	11/16	17.46	16.76	19.30	32.51	39.87
FLMC-0608N	3/8	9.52	1/2	7.11	7/8	22.22	11/16	17.46	16.76	19.30	38.86	46.22
FLMC-0612N	3/8	9.52	3/4	7.11	1-1/16	26.98	11/16	17.46	16.76	19.30	40.38	47.75
FLMC-0802N	1/2	12.70	1/8	4.82	13/16	20.63	7/8	22.22	22.86	21.84	28.70	38.86
FLMC-0804N	1/2	12.70	1/4	7.11	13/16	20.63	7/8	22.22	22.86	21.84	33.27	43.43
FLMC-0806N	1/2	12.70	3/8	9.65	13/16	20.63	7/8	22.22	22.86	21.84	33.27	43.43
FLMC-0808N	1/2	12.70	1/2	10.41	7/8	22.22	7/8	22.22	22.86	21.84	38.86	49.02
FLMC-0812N	1/2	12.70	3/4	10.41	1-1/16	26.98	7/8	22.22	22.86	21.84	40.38	50.54
FLMC-0816N	1/2	12.70	1	10.41	1-3/8	34.92	7/8	22.22	22.86	21.84	46.99	57.15
FLMC-1208N	3/4	19.05	1/2	11.93	1-1/16	26.98	1-1/8	28.57	24.38	21.84	40.38	50.54
FLMC-1212N	3/4	19.05	3/4	15.74	1-1/16	26.98	1-1/8	28.57	24.38	21.84	40.38	50.54
FLMC-1216N	3/4	19.05	1	15.74	1-3/8	34.92	1-1/8	28.57	24.38	21.84	46.99	57.15
FLMC-1608N	1	25.40	1/2	11.93	1-3/8	34.92	1-1/2	38.10	31.24	26.41	45.21	57.40
FLMC-1612N	1	25.40	3/4	15.74	1-3/8	34.92	1-1/2	38.10	31.24	26.41	45.21	57.40
FLMC-1616N	1	25.40	1	22.35	1-3/8	34.92	1-1/2	38.10	31.24	26.41	50.03	62.23

Male Connector PT (Metric Size)

Connects Metric Tube To Female PT Thread

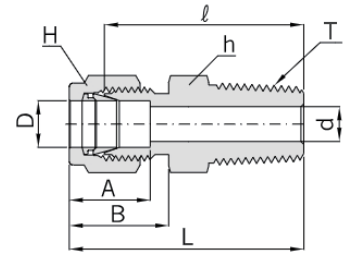

(Unit:mm)

HIFLUX

Catalog No.	Tube O.D. D	T* PT Size	d+ Min.	Width Across Flat		A	B	ℓ	L
				h	H				
FLMC-M0202R	2	1/8	1.7	12	12	12.9	15.3	23.9	30.5
FLMC-M0402R	4	1/8	2.4	12	12	13.7	16.1	24.6	31.2
FLMC-M0404R	4	1/4	2.4	14	12	13.7	16.1	29.7	36.3
FLMC-M0602R	6	1/8	4.8	14	14	15.3	17.7	25.4	32.8
FLMC-M0604R	6	1/4	4.8	14	14	15.3	17.7	30.5	37.9
FLMC-M0606R	6	3/8	4.8	17	14	15.3	17.7	31.0	38.4
FLMC-M0608R	6	1/2	4.8	22	14	15.3	17.7	37.3	44.7
FLMC-M0802R	8	1/8	4.8	14	16	16.2	18.6	26.7	34.2
FLMC-M0804R	8	1/4	6.3	14	16	16.2	18.6	31.2	38.7
FLMC-M0806R	8	3/8	6.3	17	16	16.2	18.6	31.8	39.2
FLMC-M0808R	8	1/2	6.3	22	16	16.2	18.6	38.1	45.6
FLMC-M1002R	10	1/8	4.8	17	19	17.2	19.5	28.7	36.3
FLMC-M1004R	10	1/4	7.1	17	19	17.2	19.5	33.3	40.9
FLMC-M1006R	10	3/8	7.9	17	19	17.2	19.5	33.3	40.9
FLMC-M1008R	10	1/2	7.9	22	19	17.2	19.5	38.9	46.5
FLMC-M1204R	12	1/4	7.1	22	22	22.8	22.0	33.3	43.4
FLMC-M1206R	12	3/8	9.5	22	22	22.8	22.0	33.3	43.4
FLMC-M1208R	12	1/2	9.5	22	22	22.8	22.0	38.9	49.0
FLMC-M1212R	12	3/4	9.5	27	22	22.8	22.0	40.4	50.5

Male Connector NPT (Metric Size)

Connects Metric Tube To Female NPT Thread

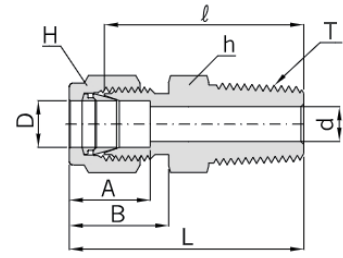

(Unit:mm)

HiFLUX

Catalog No.	Tube O.D. D	T* NPT Size	d+ Min.	Width Across Flat		A	B	l	L
				h	H				
FLMC-M0202N	2	1/8	1.7	12	12	12.9	15.3	23.9	30.5
FLMC-M0402N	4	1/8	2.4	12	12	13.7	16.1	24.6	31.2
FLMC-M0404N	4	1/4	2.4	14	12	13.7	16.1	29.7	36.3
FLMC-M0602N	6	1/8	4.8	14	14	15.3	17.7	25.4	32.8
FLMC-M0604N	6	1/4	4.8	14	14	15.3	17.7	30.5	37.9
FLMC-M0606N	6	3/8	4.8	17	14	15.3	17.7	31	38.4
FLMC-M0608N	6	1/2	4.8	22	14	15.3	17.7	37.3	44.7
FLMC-M0802N	8	1/8	4.8	14	16	16.2	18.6	26.7	34.2
FLMC-M0804N	8	1/4	6.3	14	16	16.2	18.6	31.2	38.7
FLMC-M0806N	8	3/8	6.3	17	16	16.2	18.6	31.8	39.2
FLMC-M0808N	8	1/2	6.3	22	16	16.2	18.6	38.1	45.6
FLMC-M1002N	10	1/8	4.8	17	19	17.2	19.5	28.7	36.3
FLMC-M1004N	10	1/4	7.1	17	19	17.2	19.5	33.3	40.9
FLMC-M1006N	10	3/8	7.9	17	19	17.2	19.5	33.3	40.9
FLMC-M1008N	10	1/2	7.9	22	19	17.2	19.5	38.9	46.5
FLMC-M1204N	12	1/4	7.1	22	22	22.8	22	33.3	43.4
FLMC-M1206N	12	3/8	9.5	22	22	22.8	22	33.3	43.4
FLMC-M1208N	12	1/2	9.5	22	22	22.8	22	38.9	49
FLMC-M1212N	12	3/4	9.5	27	22	22.8	22	40.4	50.5

Female Connector PT (Fractional Size)

Connects Metric Tube To Female PT Thread

HiFLUX

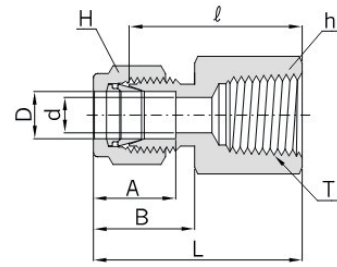

(Unit:mm)

Catalog No.	Tube O.D. D		T* PT Size	d+ Min.	Width Across Flat(in.)				A	B	l	L
	in	mm			h		H					
					in	mm	in	mm				
FLFC-0202R	1/8	3.17	1/8	2.28	9/16	14.28	7/16	11.11	12.70	15.24	22.09	28.70
FLFC-0204R	1/8	3.17	1/4	2.28	3/4	19.05	7/16	11.11	12.70	15.24	26.92	33.52
FLFC-0402R	1/4	6.35	1/8	4.82	9/16	14.28	9/16	14.28	15.24	17.78	23.87	31.24
FLFC-0404R	1/4	6.35	1/4	4.82	3/4	19.05	9/16	14.28	15.24	17.78	28.44	35.81
FLFC-0406R	1/4	6.35	3/8	4.82	7/8	22.22	9/16	14.28	15.24	17.78	30.22	37.59
FLFC-0408R	1/4	6.35	1/2	4.82	1-1/16	26.98	9/16	14.28	15.24	17.78	35.05	42.41
FLFC-0602R	3/8	9.52	1/8	7.11	5/8	15.87	11/16	17.46	16.76	19.30	25.40	32.76
FLFC-0604R	3/8	9.52	1/4	7.11	3/4	19.05	11/16	17.46	16.76	19.30	30.22	37.59
FLFC-0606R	3/8	9.52	3/8	7.11	7/8	22.22	11/16	17.46	16.76	19.30	31.75	39.11
FLFC-0608R	3/8	9.52	1/2	7.11	1-1/16	26.98	11/16	17.46	16.76	19.30	36.57	43.94
FLFC-0612R	3/8	9.52	3/4	7.11	1-5/16	33.33	11/16	17.46	16.76	19.30	40.38	47.75
FLFC-0804R	1/2	12.70	1/4	10.41	13/16	20.63	7/8	22.22	22.86	21.84	30.22	40.38
FLFC-0806R	1/2	12.70	3/8	10.41	7/8	22.22	7/8	22.22	22.86	21.84	31.75	41.91
FLFC-0808R	1/2	12.70	1/2	10.41	1-1/16	26.98	7/8	22.22	22.86	21.84	36.57	46.73
FLFC-0812R	1/2	12.70	3/4	10.41	1-5/16	33.33	7/8	22.22	22.86	21.84	38.10	48.26
FLFC-1208R	3/4	19.05	1/2	15.74	1-1/16	26.98	1-1/8	28.57	24.38	21.84	36.57	46.73
FLFC-1212R	3/4	19.05	3/4	15.74	1-5/16	33.33	1-1/8	28.57	24.38	21.84	38.10	48.26
FLFC-1612R	1	25.40	3/4	22.35	1-3/8	34.92	1-1/2	38.10	31.24	26.41	41.14	53.34
FLFC-1616R	1	25.40	1	22.35	1-5/8	41.27	1-1/2	38.10	31.24	26.41	50.03	62.23

Female Connector NPT (Fractional Size)

Connects Metric Tube To Female NPT Thread

HiFLUX

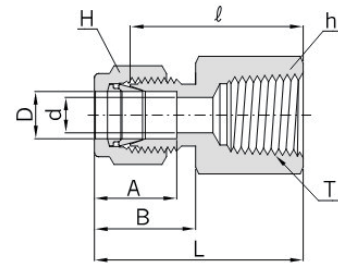

(Unit:mm)

Catalog No.	Tube O.D. D		T* NPT Size	d+ Min.	Width Across Flat(in.)				A	B	ℓ	L
	in	mm			h		H					
					in	mm	in	mm				
FLFC-0202N	1/8	3.17	1/8	2.28	9/16	14.28	7/16	11.11	12.70	15.24	22.09	28.70
FLFC-0204N	1/8	3.17	1/4	2.28	3/4	19.05	7/16	11.11	12.70	15.24	26.92	33.52
FLFC-0402N	1/4	6.35	1/8	4.82	9/16	14.28	9/16	14.28	15.24	17.78	23.87	31.24
FLFC-0404N	1/4	6.35	1/4	4.82	3/4	19.05	9/16	14.28	15.24	17.78	28.44	35.81
FLFC-0406N	1/4	6.35	3/8	4.82	7/8	22.22	9/16	14.28	15.24	17.78	30.22	37.59
FLFC-0408N	1/4	6.35	1/2	4.82	1-1/16	26.98	9/16	14.28	15.24	17.78	35.05	42.41
FLFC-0602N	3/8	9.52	1/8	7.11	5/8	15.87	11/16	17.46	16.76	19.30	25.40	32.76
FLFC-0604N	3/8	9.52	1/4	7.11	3/4	19.05	11/16	17.46	16.76	19.30	30.22	37.59
FLFC-0606N	3/8	9.52	3/8	7.11	7/8	22.22	11/16	17.46	16.76	19.30	31.75	39.11
FLFC-0608N	3/8	9.52	1/2	7.11	1-1/16	26.98	11/16	17.46	16.76	19.30	36.57	43.94
FLFC-0612N	3/8	9.52	3/4	7.11	1-5/16	33.33	11/16	17.46	16.76	19.30	40.38	47.75
FLFC-0804N	1/2	12.70	1/4	10.41	13/16	20.63	7/8	22.22	22.86	21.84	30.22	40.38
FLFC-0806N	1/2	12.70	3/8	10.41	7/8	22.22	7/8	22.22	22.86	21.84	31.75	41.91
FLFC-0808N	1/2	12.70	1/2	10.41	1-1/16	26.98	7/8	22.22	22.86	21.84	36.57	46.73
FLFC-0812N	1/2	12.70	3/4	10.41	1-5/16	33.33	7/8	22.22	22.86	21.84	38.10	48.26
FLFC-1208N	3/4	19.05	1/2	15.74	1-1/16	26.98	1-1/8	28.57	24.38	21.84	36.57	46.73
FLFC-1212N	3/4	19.05	3/4	15.74	1-5/16	33.33	1-1/8	28.57	24.38	21.84	38.10	48.26
FLFC-1612N	1	25.40	3/4	22.35	1-3/8	34.92	1-1/2	38.10	31.24	26.41	41.14	53.34
FLFC-1616N	1	25.40	1	22.35	1-5/8	41.27	1-1/2	38.10	31.24	26.41	50.03	62.23

Male Adapter PT

Connects Fractional Port To Male PT Thread

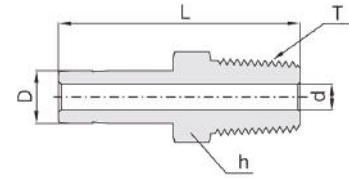

HIFLUX

(Unit:mm)

Catalog No.	Tube O.D. (D)		T* (PT)	d (mm)	Width Across Flat (h)		L
	in	mm			in.	mm	
FLMA-02T02R	1/8"	3.17	1/8"	2.03	7/16"	11.11	29.5
FLMA-02T04R	1/8"	3.17	1/4"	2.03	9/16"	14.28	34.8
FLMA-04T02R	1/4"	6.35	1/8"	4.32	7/16"	11.11	31.8
FLMA-04T04R	1/4"	6.35	1/4"	4.32	9/16"	14.28	37.08
FLMA-04T06R	1/4"	6.35	3/8"	4.32	11/16"	17.46	37.84
FLMA-06T02R	3/8"	9.52	1/8"	4.83	7/16"	11.11	33.5
FLMA-06T04R	3/8"	9.52	1/4"	6.86	9/16"	14.28	38.9
FLMA-06T06R	3/8"	9.52	3/8"	6.86	11/16"	17.46	39.6
FLMA-06T08R	3/8"	9.52	1/2"	6.86	7/8"	22.22	45.2
FLMA-08T04R	1/2"	12.7	1/4"	7.11	9/16"	14.28	44.5
FLMA-08T06R	1/2"	12.7	3/8"	9.4	11/16"	17.46	45.2
FLMA-08T08R	1/2"	12.7	1/2"	9.4	7/8"	22.22	50.8
FLMA-12T08R	3/4"	19.05	1/2"	11.94	7/8"	22.22	52.3
FLMA-12T12R	3/4"	19.05	3/4"	14.73	1-1/16"	26.98	52.3
FLMA-16T16R	1"	25.4	1"	20.32	1-3/8"	34.92	66

Male Adapter NPT

Connects Fractional Port To Male NPT Thread

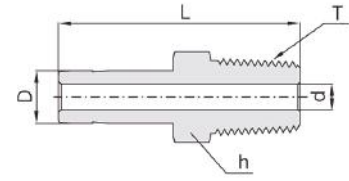

HIFLUX

(Unit:mm)

Catalog No.	Tube O.D (D)		T* (NPT)	d (mm)	Width Across Flat (h)		L
	in	mm			in	mm	
FLMA-02T02N	1/8"	3.17	1/8"	2.03	7/16"	11.11	29.5
FLMA-02T04N	1/8"	3.17	1/4"	2.03	9/16"	14.28	34.8
FLMA-04T02N	1/4"	6.35	1/8"	4.32	7/16"	11.11	31.8
FLMA-04T04N	1/4"	6.35	1/4"	4.32	9/16"	14.28	37.08
FLMA-04T06N	1/4"	6.35	3/8"	4.32	11/16"	17.46	37.84
FLMA-06T02N	3/8"	9.52	1/8"	4.83	7/16"	11.11	33.5
FLMA-06T04N	3/8"	9.52	1/4"	6.86	9/16"	14.28	38.9
FLMA-06T06N	3/8"	9.52	3/8"	6.86	11/16"	17.46	39.6
FLMA-06T08N	3/8"	9.52	1/2"	6.86	7/8"	22.22	45.2
FLMA-08T04N	1/2"	12.7	1/4"	7.11	9/16"	14.28	44.5
FLMA-08T06N	1/2"	12.7	3/8"	9.4	11/16"	17.46	45.2
FLMA-08T08N	1/2"	12.7	1/2"	9.4	7/8"	22.22	50.8
FLMA-12T08N	3/4"	19.05	1/2"	11.94	7/8"	22.22	52.3
FLMA-12T12N	3/4"	19.05	3/4"	14.73	1-1/16"	26.98	52.3
FLMA-16T16N	1"	25.4	1"	20.32	1-3/8"	34.92	66

Female Adapter PT

Connects Fractional Port To Male PT Thread

HiFLUX

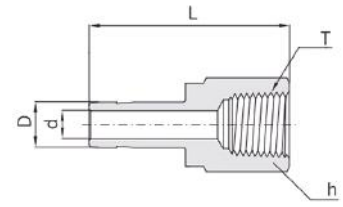

(Unit:mm)

Catalog No.	Tube O.D (D)		T* (PT)	d (mm)	Width Across Flat h		L
	in.	mm			in.	mm	
FLFA-02T02R	1/8"	3.17	1/8"	2.03	9/16"	14.28	31.50
FLFA-04T04R	1/4"	6.35	1/4"	4.32	3/4"	19.05	37.10
FLFA-06T06R	3/8"	9.52	3/8"	6.86	7/8"	22.22	40.38
FLFA-08T08R	1/2"	12.70	1/2"	9.40	1-1/16"	26.98	51.80
FLFA-12T12R	3/4"	19.05	3/4"	14.73	1-5/16"	33.33	54.86
FLFA-16T16R	1"	25.40	1"	20.32	1-5/8"	41.27	64.26

Female Adapter NPT

Connects Fractional Port To Male NPT Thread

HiFLUX

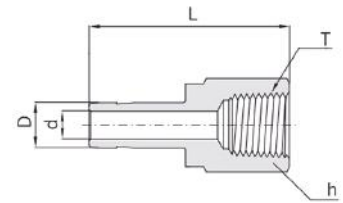

(Unit:mm)

Catalog No.	Tube O.D (D)		T* (NPT)	d (mm)	Width Across Flat h		L
	in	mm			in	mm	
FLFA-02T02N	1/8"	3.17	1/8"	2.03	9/16"	14.28	31.50
FLFA-04T04N	1/4"	6.35	1/4"	4.32	3/4"	19.05	37.10
FLFA-06T06N	3/8"	9.52	3/8"	6.86	7/8"	22.22	40.38
FLFA-08T08N	1/2"	12.70	1/2"	9.40	1-1/16"	26.98	51.80
FLFA-12T12N	3/4"	19.05	3/4"	14.73	1-5/16"	33.33	54.86
FLFA-16T16N	1"	25.40	1"	20.32	1-5/8"	41.27	64.26

Cap

Connects Fractional Tube End

HiFLUX

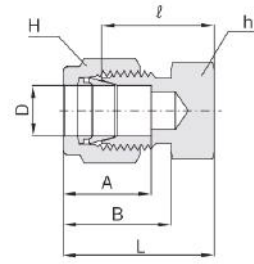

(Unit:mm)

Catalog No.	Tube O.D (D)		Width Across Flat				A	B	l	L
			h		H					
	in	mm	in	mm	in	mm				
FLC-02	1/8"	3.17	7/16"	11.11	7/16"	11.11	12.70	15.24	13.46	20.06
FLC-04	1/4"	6.35	1/2"	12.70	9/16"	14.28	15.24	17.78	16.00	23.26
FLC-06	3/8"	9.52	5/8"	15.87	11/16"	17.46	16.76	19.30	18.28	25.65
FLC-08	1/2"	12.70	13/16"	20.63	7/8"	22.22	22.86	21.84	19.05	29.21
FLC-12	3/4"	19.05	1-1/16"	26.98	1-1/8"	28.57	24.38	21.84	21.33	31.49
FLC-16	1"	25.40	1-3/8"	34.92	1-1/2"	38.10	31.24	26.41	26.16	38.35

Reducer

Connects Fractional Tube To Fractional Port

HiFLUX

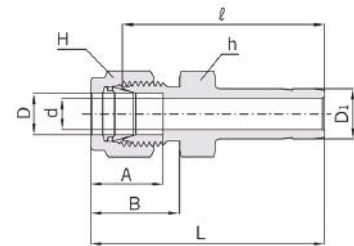

(Unit:mm)

Catalog No.	Tube O.D.				d Min	Width Across Flat				A	B	l	L
	D		D1			h		H					
	in	mm	in	mm		in	mm	in	mm				
FLR-0204T	1/8"	3.17	1/4"	6.35	2.28	7/16"	11.11	7/16"	11.11	12.70	15.24	29.46	36.06
FLR-0402T	1/4"	6.35	1/8"	3.17	2.03	1/2"	12.70	9/16"	14.28	15.24	17.78	29.46	36.83
FLR-0406T	1/4"	6.35	3/8"	9.52	4.82	1/2"	12.70	9/16"	14.28	15.24	17.78	33.27	40.64
FLR-0604T	3/8"	9.52	1/4"	6.32	4.32	5/8"	15.87	11/16"	17.46	16.76	19.30	34.03	41.40
FLR-0608T	3/8"	9.52	1/2"	12.70	7.11	5/8"	15.87	11/16"	17.46	16.76	19.30	41.14	48.51
FLR-0804T	1/2"	12.70	1/4"	6.35	4.32	13/16"	20.63	7/8"	22.22	22.86	21.84	34.79	44.95
FLR-0806T	1/2"	12.70	3/8"	9.52	6.86	13/16"	20.63	7/8"	22.22	22.86	21.84	36.57	46.73

Plug

Connects Fractional Port

HIFLUX

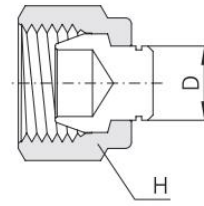

(Unit:mm)

Catalog No.	Tube O.D (D)		Width across flat H	
	in	mm	in	mm
FLP-02	1/8"	3.17	7/16"	11.11
FLP-04	1/4"	6.35	9/16"	14.28
FLP-06	3/8"	9.52	11/16"	17.46
FLP-08	1/2"	12.70	7/8"	22.22
FLP-12	3/4"	19.05	1-1/8"	28.57
FLP-16	1"	25.40	1-1/2"	38.10

Thermocouple Male Connector NPT

Connects Fractional Tube To Female NPT Thread

HIFLUX

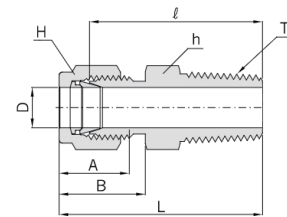

(Unit:mm)

Catalog No.	Tube O.D. (D)		T* (NPT) size	Width Across Flat		A	B	ℓ	L
	in	mm		h	H				
FLTMC-0206N	1/8"	3.17	3/8"	11/16"	7/16"	12.70	15.24	29.21	35.81
FLTMC-0406N	1/4"	6.35	3/8"	11/16"	9/16"	15.24	17.78	30.98	38.35
FLTMC-0408N	1/4"	6.35	1/2"	7/8"	9/16"	15.24	17.78	37.33	44.70

Ferrule Set

Ferrule Set

HiFLUX

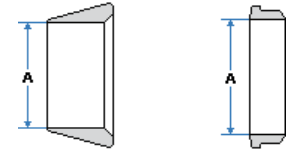

(Unit:mm)

Catalog No.	Tube Size (inch)	Tube Size (mm)
FLFS-1	1/16"	1.58
FLFS-2	1/8"	3.17
FLFS-4	1/4"	6.35
FLFS-6	3/8"	9.52
FLFS-8	1/2"	12.7
FLFS-12	3/4"	19.05
FLFS-16	1"	25.4

Front Ferrule

Ferrule Set

HiFLUX



(Unit:mm)

Catalog No.	Tube Size	A
FL01-1	1/16"	1.58
FL01-2	1/8"	3.17
FL01-4	1/4"	6.35
FL01-6	3/8"	9.52
FL01-8	1/2"	12.7
FL01-12	3/4"	19.05
FL01-16	1"	25.4

Back Ferrule

Ferrule Set

HiFLUX



(Unit:mm)

Catalog No.	Tube Size	A
FL02-1	1/16"	1.58
FL02-2	1/8"	3.17
FL02-4	1/4"	6.35
FL02-6	3/8"	9.52
FL02-8	1/2"	12.7
FL02-12	3/4"	19.05
FL02-16	1"	25.4

Port Connector

Connects Two Fractional Ports

HiFLUX

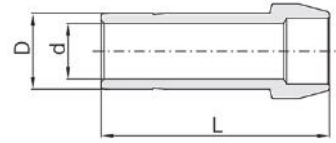

(Unit:mm)

Catalog No.	Tube O.D. (D)		d Min	L
	in	mm		
FLPC-0202T	1/8"	3.17	2.03	22.35
FLPC-0404T	1/4"	6.35	4.32	24.89
FLPC-0606T	3/8"	9.52	6.86	26.67
FLPC-0808T	1/2"	12.7	9.4	36.32
FLPC-1212T	3/4"	19.05	14.73	37.85
FLPC-1616T	1"	25.4	20.32	49.28

Fitting Nut

Connects Fractional Tube To Female PT Thread

HiFLUX

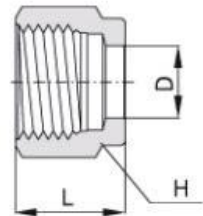

(Unit:mm)

Catalog No.	Tube O.D. (D)		Width Across Flat (H)		L
	in	mm	in	mm	
FL03-1	1/16	1.58	5/16	7.94	7.90
FL03-2	1/8	3.17	7/16	11.11	11.93
FL03-4	1/4	6.35	9/16	14.28	12.70
FL03-6	3/8	9.52	11/16	17.46	14.22
FL03-8	1/2	12.70	7/8	22.22	17.52
FL03-12	3/4	19.05	1-1/8	28.57	17.52
FL03-16	1	25.4	1-1/2	38.10	20.57

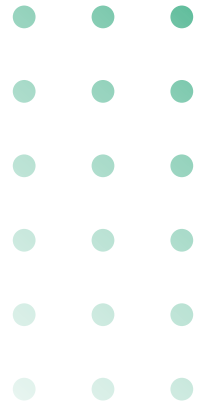

AN Adapter

Perfect Connection, Solid Trust

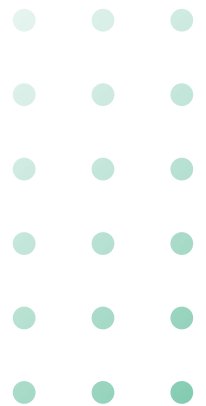

AN Tube Adapter

Connects Fractional Port To AN Flared Tube

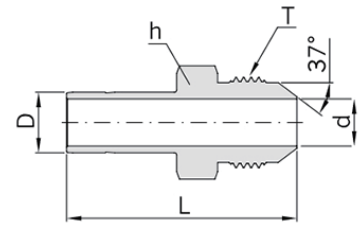

HiFLUX

(Unit:mm)

Catalog No.	Tube O.D (D)		AN Tube O.D. (D)		Straight Thread T(U)	d min.	Width Across Flat h		L
	in	mm	in	mm			in	mm	
FLATA-0404	1/4"	6.35	1/4"	6.35	7/16-20"	4.32	1/2"	12.70	37.08
FLATA-0606	3/8"	9.52	3/8"	9.52	9/16-18"	6.86	5/8"	15.87	39.62
FLATA-0808	1/2"	12.70	1/2"	12.70	3/4-16"	9.40	13/16"	20.63	48.51

AN Female Adapter

Connects Fractional Port To Male AN

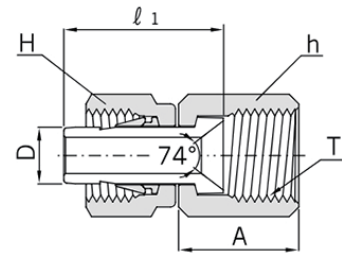
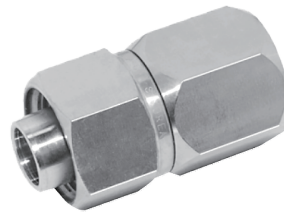

(Unit:mm)

Catalog No.	Tube O.D (D)		AN Tube O.D.		Straight Thread T(U)	Width Across Flat (in.)				A	l1
	in	mm	in	mm		h		H			
						in	mm	in	mm		
FLAFA-0204	1/8"	3.17	1/4"	6.35	7/16-20	9/16"	14.28	7/16"	11.11	15.74	19.05
FLAFA-0404	1/4"	6.35	1/4"	6.35	7/16-20	9/16"	14.28	9/16"	14.28	15.74	21.33
FLAFA-0606	3/8"	9.52	3/8"	9.52	9/16-18	11/16"	17.46	11/16"	17.46	18.28	24.89
FLAFA-0808	1/2"	12.7	1/2"	12.7	3/4-16	7/8"	22.22	7/8"	22.22	21.59	33

AN Union

Connects Fractional Tubes

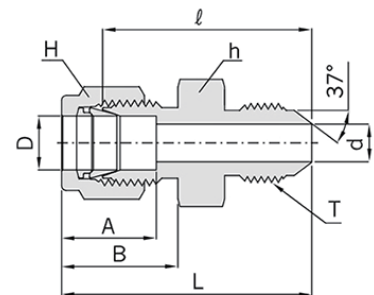

(Unit:mm)

Catalog No.	Tube O.D (D)		*AN Tube Flare Size		Straight Thread T(U)	d Min.	Width Across Flat (in.)				A	B	l	L
	in	mm	in	mm			h		H					
							in	mm	in	mm				
FLAU-0204	1/8"	3.17	1/4"	6.35	7/16-20	2.28	1/2"	12.70	7/16"	11.11	12.70	15.24	28.44	35.05
FLAU-0404	1/4"	6.35	1/4"	6.35	7/16-20	4.31	1/2"	12.70	9/16"	14.28	15.24	17.78	30.22	37.59
FLAU-0604	3/8"	9.52	1/4"	6.35	7/16-20	4.31	5/8"	15.87	11/16"	17.46	16.76	19.30	32.25	39.62
FLAU-0606	3/8"	9.52	3/8"	9.52	9/16-18	7.11	5/8"	15.87	11/16"	17.46	16.76	19.30	32.25	39.62
FLAU-0808	1/2"	12.70	1/2"	12.70	3/4-16	9.90	13/16"	20.63	7/8"	22.22	22.86	21.84	35.81	45.97
FLAU-1212	3/4"	19.05	3/4"	19.05	1-1/16-12	15.49	1-1/8"	28.57	1-1/8"	28.57	24.38	21.84	43.18	53.34
FLAU-1616	1"	25.40	1"	25.40	1-5/16-12	21.33	1-3/8"	34.92	1-1/2"	38.10	31.24	26.41	49.27	61.46

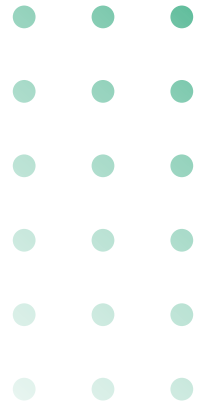

Pipe Fitting

Perfect Connection, Solid Trust

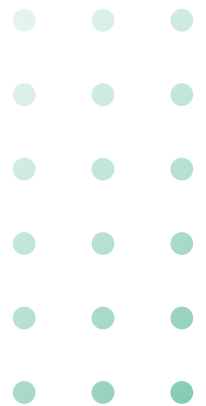

Vent Protector (VP - Male PT)

Pipe Fitting

HiFLUX

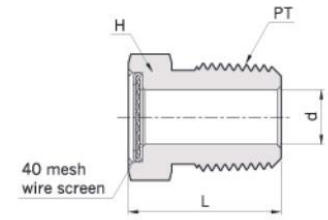

(Unit:mm)

Catalog No.	Pipe Size	L	d	H width Across flat
FL-VP-02R	1/8"	15.3	4.8	11.1
FL-VP-04R	1/4"	19.8	7.1	14.2
FL-VP-06R	3/8"	20.6	10.4	17.4
FL-VP-08R	1/2"	26.2	12.7	22.2
FL-VP-12R	3/4"	26.9	18.3	26.9

Vent Protector (VP - Male NPT)

Pipe Fitting

HiFLUX

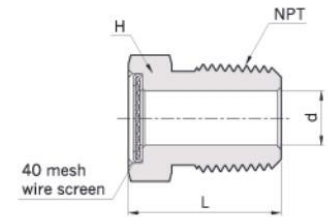

(Unit:mm)

Catalog No.	Pipe Size	L	d	H width Across flat
FL-VP-02N	1/8"	15.3	4.8	11.1
FL-VP-04N	1/4"	19.8	7.1	14.2
FL-VP-06N	3/8"	20.6	10.4	17.4
FL-VP-08N	1/2"	26.2	12.7	22.2
FL-VP-12N	3/4"	26.9	18.3	26.9

Run Tee (RT) PT

Pipe Fitting

HIFLUX

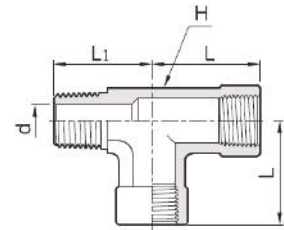

(Unit:mm)

Catalog No.	Pipe Size	L	L1	d	H width Across flat	Pressure Rating			
						SS316 Carbon Steel		Brass	
						psig	bar	psig	bar
P-RT-02R	1/8"	24	19.6	4.8	12.7	6,500	447	3,200	220
P-RT-04R	1/4"	29	26.5	7.1	17.5	6,600	454	3,300	227
P-RT-06R	3/8"	34.5	28.2	9.6	20.6	5,300	365	2,600	179
P-RT-08R	1/2"	37	35.3	11.9	25.4	4,900	337	2,400	165
P-RT-12R	3/4"	46.5	39.6	15.7	31.8	4,600	316	2,300	158
P-RT-16R	1"	48.8	49.2	22.3	42.9	4,400	303	2,200	151

Run Tee (RT) NPT

Pipe Fitting

HIFLUX

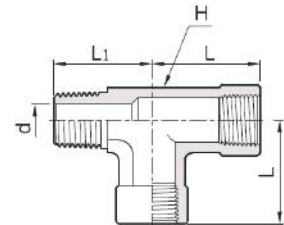

(Unit:mm)

Catalog No.	Pipe Size	L	L1	d	H width Across flat	Pressure Rating			
						SS316 Carbon Steel		Brass	
						psig	bar	psig	bar
P-RT-02N	1/8"	24	19.6	4.8	12.7	6,500	447	3,200	220
P-RT-04N	1/4"	29	26.5	7.1	17.5	6,600	454	3,300	227
P-RT-06N	3/8"	34.5	28.2	9.6	20.6	5,300	365	2,600	179
P-RT-08N	1/2"	37	35.3	11.9	25.4	4,900	337	2,400	165
P-RT-12N	3/4"	46.5	39.6	15.7	31.8	4,600	316	2,300	158
P-RT-16N	1"	48.8	49.2	22.3	42.9	4,400	303	2,200	151

Pipe Plug (PP - Male PT)

Pipe Fitting

HiFLUX



(Unit:mm)

Catalog No.	Pipe Size	L	H width Across flat
FL-PP-02R	1/8"	19.05	11.1
FL-PP-04R	1/4"	24.1	14.2
FL-PP-06R	3/8"	25	17.4
FL-PP-08R	1/2"	30.5	22.2
FL-PP-12R	3/4"	30.5	26.9
FL-PP-16R	1"	38.1	34.9

Pipe Plug (PP - Male NPT)

Pipe Fitting

HiFLUX



(Unit:mm)

Catalog No.	Pipe Size	L	H width Across flat
FL-PP-02N	1/8"	19.05	11.1
FL-PP-04N	1/4"	24.1	14.2
FL-PP-06N	3/8"	25	17.4
FL-PP-08N	1/2"	30.5	22.2
FL-PP-12N	3/4"	30.5	26.9
FL-PP-16N	1"	38.1	34.9

Male Tee (MT) PT

Pipe Fitting

HiFLUX

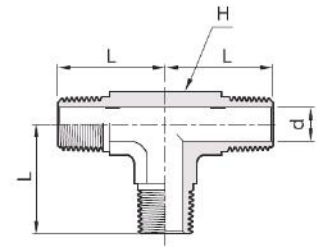

(Unit:mm)

Catalog No.	Pipe Size	L	d	H width Across flat	Pressure Rating			
					SS316 Carbon Steel		Brass	
					psig	bar	psig	bar
P-MT-02R	1/8"	19.05	4.8	12.7	10,000	689	5,000	344
P-MT-04R	1/4"	24.5	7.1	12.7	8,000	551	4,000	275
P-MT-06R	3/8"	26.9	9.6	17.5	7,800	537	3,900	268
P-MT-08R	1/2"	33.2	11.9	20.6	7,700	530	3,800	261
P-MT-12R	3/4"	35.3	15.7	25.4	7,300	502	3,600	248
P-MT-16R	1"	44.5	22.3	31.8	5,300	365	2,600	179

Male Tee (MT) NPT

Pipe Fitting

HiFLUX

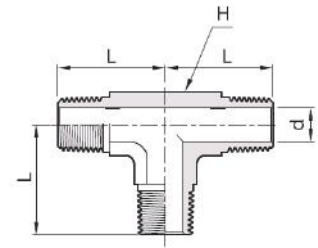

(Unit:mm)

Catalog No.	Pipe Size	L	d	H width Across flat	Pressure Rating			
					SS316 Carbon Steel		Brass	
					psig	bar	psig	bar
P-MT-02N	1/8"	19.05	4.8	12.7	10,000	689	5,000	344
P-MT-04N	1/4"	24.5	7.1	12.7	8,000	551	4,000	275
P-MT-06N	3/8"	26.9	9.6	17.5	7,800	537	3,900	268
P-MT-08N	1/2"	33.2	11.9	20.6	7,700	530	3,800	261
P-MT-12N	3/4"	35.3	15.7	25.4	7,300	502	3,600	248
P-MT-16N	1"	44.5	22.3	31.8	5,300	365	2,600	179

Male Elbow (ML) PT

Pipe Fitting

HIFLUX

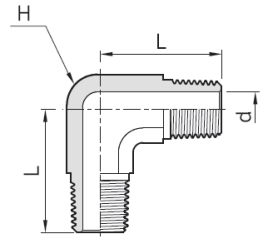

(Unit:mm)

Catalog No.	Pipe Size	L	d	H width Across flat	Pressure Rating			
					SS316 Carbon Steel		Brass	
					psig	bar	psig	bar
P-ML-02R	1/8"	19.05	4.8	12.7	10,000	689	5,000	344
P-ML-04R	1/4"	24.5	7.1	12.7	8,000	551	4,000	275
P-ML-06R	3/8"	26.9	9.6	17.5	7,800	537	3,900	268
P-ML-08R	1/2"	33.2	11.9	20.6	7,700	530	3,800	261
P-ML-12R	3/4"	35.3	15.7	25.4	7,300	502	3,600	248
P-ML-16R	1"	44.5	22.3	31.8	5,300	365	2,600	179

Male Elbow (ML) NPT

Pipe Fitting

HIFLUX

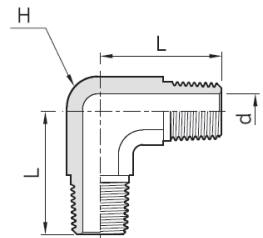

(Unit:mm)

Catalog No.	Pipe Size	L	d	H width Across flat	Pressure Rating			
					SS316 Carbon Steel		Brass	
					psig	bar	psig	bar
P-ML-02N	1/8"	19.05	4.8	12.7	10,000	689	5,000	344
P-ML-04N	1/4"	24.5	7.1	12.7	8,000	551	4,000	275
P-ML-06N	3/8"	26.9	9.6	17.5	7,800	537	3,900	268
P-ML-08N	1/2"	33.2	11.9	20.6	7,700	530	3,800	261
P-ML-12N	3/4"	35.3	15.7	25.4	7,300	502	3,600	248
P-ML-16N	1"	44.5	22.3	31.8	5,300	365	2,600	179

Reducing Street Elbow (MFRL) PT

Pipe Fitting

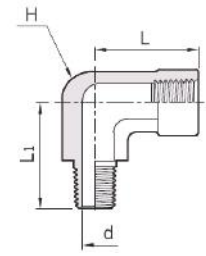

(Unit:mm)

Catalog No.	Pipe Size	Male Pipe Size	L	L1	d	H width Across flat	Pressure Rating			
							SS316 Carbon Steel		Brass	
							psig	bar	psig	bar
P-MFRL-0402R	1/4"	1/8"	29	22.4	4.8	17.5	6,500	447	3,200	220
P-MFRL-0604R	3/8"	1/4"	34.5	28.2	7.1	20.6	5,300	365	2,600	179
P-MFRL-0804R	1/2"	1/4"	37	30.5	7.1	25.4	4,900	337	2,400	165
P-MFRL-0806R	1/2"	3/8"	37	30.5	9.6	25.4	4,900	337	2,400	165
P-MFRL-1208R	3/4"	1/2"	46.5	39.6	11.9	31.8	4,600	316	2,300	158
P-MFRL-1608R	1"	1/2"	48.8	44.5	11.9	42.9	4,400	303	2,200	151

Reducing Street Elbow (MFRL) NPT

Pipe Fitting

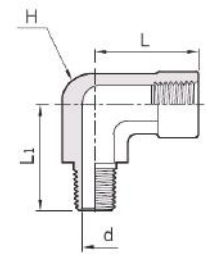

(Unit:mm)

Catalog No.	Pipe Size	Male Pipe Size	L	L1	d	H width Across flat	Pressure Rating			
							SS316 Carbon Steel		Brass	
							psig	bar	psig	bar
P-MFRL-0402N	1/4"	1/8"	29	22.4	4.8	17.5	6,500	447	3,200	220
P-MFRL-0604N	3/8"	1/4"	34.5	28.2	7.1	20.6	5,300	365	2,600	179
P-MFRL-0804N	1/2"	1/4"	37	30.5	7.1	25.4	4,900	337	2,400	165
P-MFRL-0806N	1/2"	3/8"	37	30.5	9.6	25.4	4,900	337	2,400	165
P-MFRL-1208N	3/4"	1/2"	46.5	39.6	11.9	31.8	4,600	316	2,300	158
P-MFRL-1608N	1"	1/2"	48.8	44.5	11.9	42.9	4,400	303	2,200	151

Street Elbow (MFL) PT

Pipe Fitting

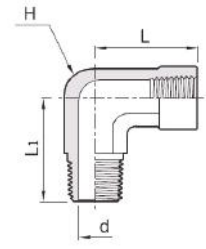

(Unit:mm)

Catalog No.	Pipe Size	L	L1	d	H width Across flat	Pressure Rating			
						SS316 Carbon Steel		Brass	
						psig	bar	psig	bar
P-MFL-02R	1/8"	24.1	19.6	4.8	12.7	6,500	447	3,200	220
P-MFL-04R	1/4"	29	26.5	7.1	17.5	6,600	454	3,300	227
P-MFL-06R	3/8"	34.5	28.2	9.6	20.6	5,300	365	2,600	179
P-MFL-08R	1/2"	37	35.3	11.9	25.4	4,900	337	2,400	165
P-MFL-12R	3/4"	46.5	39.6	15.7	31.8	4,600	316	2,300	158
P-MFL-16R	1"	48.8	49.2	22.3	42.9	4,400	303	2,200	151

Street Elbow (MFL) NPT

Pipe Fitting

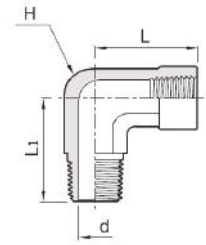

(Unit:mm)

Catalog No.	Pipe Size	L	L1	d	H width Across flat	Pressure Rating			
						SS316 Carbon Steel		Brass	
						psig	bar	psig	bar
P-MFL-02N	1/8"	24.1	19.6	4.8	12.7	6,500	447	3,200	220
P-MFL-04N	1/4"	29	26.5	7.1	17.5	6,600	454	3,300	227
P-MFL-06N	3/8"	34.5	28.2	9.6	20.6	5,300	365	2,600	179
P-MFL-08N	1/2"	37	35.3	11.9	25.4	4,900	337	2,400	165
P-MFL-12N	3/4"	46.5	39.6	15.7	31.8	4,600	316	2,300	158
P-MFL-16N	1"	48.8	49.2	22.3	42.9	4,400	303	2,200	151

Hex Reducing Nipple (HRN - Male PT)

Pipe Fitting

HiFLUX

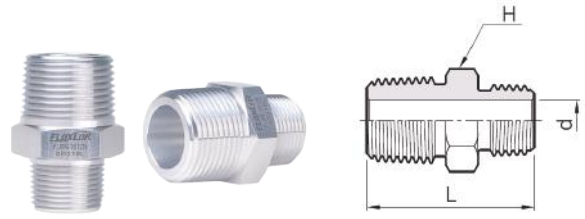

(Unit:mm)

Catalog No.	Pipe Size	Reduced Pipe Size	L	d	H width Across flat	Pressure Rating			
						SS316 Carbon Steel		Brass	
						psig	bar	psig	bar
FL-HRN-0402R	1/4"	1/8"	30.7	4.8	14.2	8,000	551	4,000	275
FL-HRN-0602R	3/8"	1/8"	32	4.8	17.4	7,800	537	3,900	268
FL-HRN-0604R	3/8"	1/4"	36.1	7.1	17.4	7,800	537	3,900	268
FL-HRN-0802R	1/2"	1/8"	37.2	4.8	22.2	7,700	530	3,800	261
FL-HRN-0804R	1/2"	1/4"	41.7	7.1	22.2	7,700	530	3,800	261
FL-HRN-0806R	1/2"	3/8"	41.7	9.6	22.2	7,700	530	3,800	261
FL-HRN-1204R	3/4"	1/4"	41.7	7.1	26.9	7,300	502	3,600	248
FL-HRN-1208R	3/4"	1/2"	46.7	11.9	26.9	7,300	502	3,600	248
FL-HRN-1604R	1"	1/4"	49.3	7.1	34.9	5,300	365	2,600	179
FL-HRN-1608R	1"	1/2"	54.1	11.9	34.9	5,300	365	2,600	179

Hex Reducing Nipple (HRN - Male NPT)

Pipe Fitting

HiFLUX

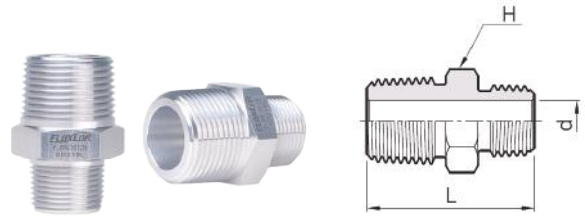

(Unit:mm)

Catalog No.	Pipe Size	Reduced Pipe Size	L	d	H width Across flat	Pressure Rating			
						SS316 Carbon Steel		Brass	
						psig	bar	psig	bar
FL-HRN-0402N	1/4"	1/8"	30.7	4.8	14.2	8,000	551	4,000	275
FL-HRN-0602N	3/8"	1/8"	32	4.8	17.4	7,800	537	3,900	268
FL-HRN-0604N	3/8"	1/4"	36.1	7.1	17.4	7,800	537	3,900	268
FL-HRN-0802N	1/2"	1/8"	37.2	4.8	22.2	7,700	530	3,800	261
FL-HRN-0804N	1/2"	1/4"	41.7	7.1	22.2	7,700	530	3,800	261
FL-HRN-0806N	1/2"	3/8"	41.7	9.6	22.2	7,700	530	3,800	261
FL-HRN-1204N	3/4"	1/4"	41.7	7.1	26.9	7,300	502	3,600	248
FL-HRN-1208N	3/4"	1/2"	46.7	11.9	26.9	7,300	502	3,600	248
FL-HRN-1604N	1"	1/4"	49.3	7.1	34.9	5,300	365	2,600	179
FL-HRN-1608N	1"	1/2"	54.1	11.9	34.9	5,300	365	2,600	179

Hex Nipple (HN - Male PT)

Pipe Fitting

HiFLUX

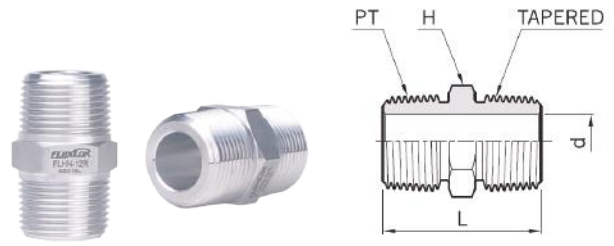

(Unit:mm)

Catalog No.	Pipe Size	L	d	H width Across flat	Pressure Rating			
					SS316 Carbon Steel		Brass	
					psig	bar	psig	bar
FL-HN-02R	1/8"	25.4	4.8	11.1	10,000	689	5,000	344
FL-HN-04R	1/4"	35.3	7.1	14.2	8,000	551	4,000	275
FL-HN-06R	3/8"	36.1	9.6	17.4	7,800	537	3,900	268
FL-HN-08R	1/2"	46.7	11.9	22.2	7,700	530	3,800	261
FL-HN-12R	3/4"	46.7	15.7	26.9	7,300	502	3,600	248
FL-HN-16R	1"	58.7	22.3	34.9	5,300	365	2,600	179

Hex Nipple (HN - Male NPT)

Pipe Fitting

HiFLUX

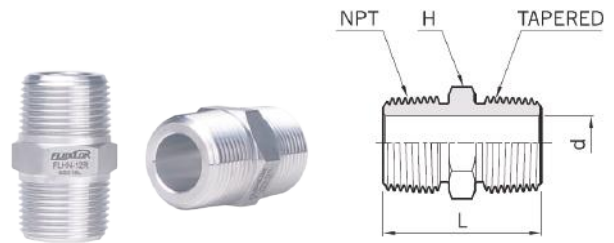

(Unit:mm)

Catalog No.	Pipe Size	L	d	H width Across flat	Pressure Rating			
					SS316 Carbon Steel		Brass	
					psig	bar	psig	bar
FL-HN-02N	1/8"	25.4	4.8	11.1	10,000	689	5,000	344
FL-HN-04N	1/4"	35.3	7.1	14.2	8,000	551	4,000	275
FL-HN-06N	3/8"	36.1	9.6	17.4	7,800	537	3,900	268
FL-HN-08N	1/2"	46.7	11.9	22.2	7,700	530	3,800	261
FL-HN-12N	3/4"	46.7	15.7	26.9	7,300	502	3,600	248
FL-HN-16N	1"	58.7	22.3	34.9	5,300	365	2,600	179

Hex Nipple (HNR - Male NPT to ISO Tapered)

Pipe Fitting

HiFLUX

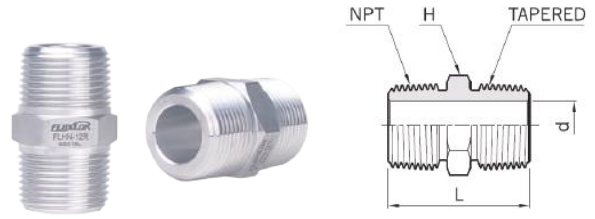

(Unit:mm)

Catalog No.	NPT Thread Size	BSP/ISO Thread Size	L	d	H width Across flat	Pressure Rating			
						SS316 Carbon Steel		Brass	
						psig	bar	psig	bar
FL-HNR-02N02R	1/8"	1/8-28 7/1	24.6	4.1	11.1	10,000	689	5,000	344
FL-HNR-04N04R	1/4"	1/4-19 7/1	35.6	6.4	14.2	8,000	551	4,000	275
FL-HNR-06N06R	3/8"	3/8-19 7/1	36.3	9.7	17.4	7,800	537	3,900	268
FL-HNR-08N08R	1/2"	1/2-14 7/1	46	11.9	22.2	7,700	530	3,800	261
FL-HNR-12N12R	3/4"	3/4-14 7/1	46.7	15.7	26.9	7,300	502	3,600	248
FL-HNR-16N16R	1"	1/11 7/1	58.9	22.4	34.9	5,300	365	2,600	179

Hex Long Nipple (HLN)

Pipe Fitting

HiFLUX

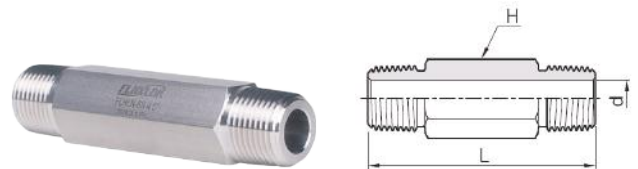

(Unit:mm)

Catalog No.	Part Size	L	d	H width Across flat	Pressure Rating			
					SS316 Carbon Steel		Brass	
					psig	bar	psig	bar
P-HLN-02N	1/8"	38/50/65/75	4.8	11.1	10,000	689	5,000	344
P-HLN-04N	1/4"	38/50/65/75/100	7.1	14.2	8,000	551	4,000	275
P-HLN-06N	3/8"	38/50/65/75/100	9.7	17.4	7,800	537	3,900	268
P-HLN-08N	1/2"	50/75/100/150	11.9	22.2	7,700	530	3,800	261
P-HLN-12N	3/4"	50/75/100	15.7	26.9	7,300	502	3,600	248
P-HLN-16N	1"	75/100	22.4	34.9	5,300	365	2,600	179

Hex Coupling (HC - Male PT)

Pipe Fitting

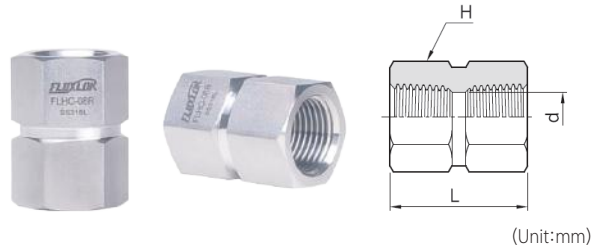

(Unit:mm)

Catalog No.	Pipe Size	L	d	H width Across flat	Pressure Rating			
					SS316 Carbon Steel		Brass	
					psig	bar	psig	bar
FL-HC-02R	1/8"	20.3	8.9	14.2	6,500	447	3,200	220
FL-HC-04R	1/4"	30	11.7	19.05	6,600	454	3,300	227
FL-HC-06R	3/8"	33	15	22.2	5,300	365	2,600	179
FL-HC-08R	1/2"	39.4	18.7	26.9	4,900	337	2,400	165
FL-HC-12R	3/4"	41	23.5	31.8	4,600	316	2,300	158
FL-HC-16R	1"	50.5	29.7	41.2	4,400	303	2,200	151

Hex Coupling (HC - Male NPT)

Pipe Fitting

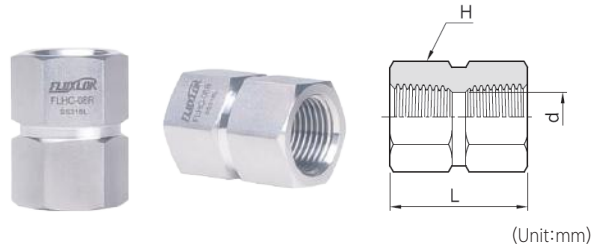

(Unit:mm)

Catalog No.	Pipe Size	L	d	H width Across flat	Pressure Rating			
					SS316 Carbon Steel		Brass	
					psig	bar	psig	bar
FL-HC-02N	1/8"	20.3	8.9	14.2	6,500	447	3,200	220
FL-HC-04N	1/4"	30	11.7	19.05	6,600	454	3,300	227
FL-HC-06N	3/8"	33	15	22.2	5,300	365	2,600	179
FL-HC-08N	1/2"	39.4	18.7	26.9	4,900	337	2,400	165
FL-HC-12N	3/4"	41	23.5	31.8	4,600	316	2,300	158
FL-HC-16N	1"	50.5	29.7	41.2	4,400	303	2,200	151

Hex Bushing (HB - Male PT)

Pipe Fitting



(Unit:mm)

Catalog No.	Male Pipe Size	Female Pipe Size	L	d	H width Across flat	Working Pressure(PSIG)			Pressure Rating			
						316SS	Brass	Carbon Steel	SS316 Carbon Steel		Brass	
									psig	bar	psig	bar
FL-HB-0402R	1/4"	1/8"	26.7	7.1	14.2	5600	3100	6200	6,500	447	3,200	220
FL-HB-0602R	3/8"	1/8"	21.8	8.5	17.4				6,500	447	3,200	220
FL-HB-0604R	3/8"	1/4"	30	9.6	19.05	5200	3100	6200	6,600	454	3,300	227
FL-HB-0802R	1/2"	1/8"	27.4	8.5	22.2				6,500	447	3,200	220
FL-HB-0804R	1/2"	1/4"	27.4	11.7	22.2	5800	3100	6200	6,600	454	3,300	227
FL-HB-0806R	1/2"	3/8"	35.6	11.9	22.2	4400	2500	5100	5,300	365	2,600	179
FL-HB-1204R	3/4"	1/4"	27.4	11.4	26.9				6,600	454	3,300	227
FL-HB-1206R	3/4"	3/8"	27.4	15	26.9				5,300	365	2,600	179
FL-HB-1208R	3/4"	1/2"	41.4	15.7	26.9				4,900	337	2,400	165
FL-HB-1604R	1"	1/4"	34.8	11.4	34.9				6,600	454	3,300	227
FL-HB-1608R	1"	1/2"	34.8	18.5	34.9				4,900	337	2,400	165
FL-HB-1612R	1"	3/4"	47	22.4	34.9				4,600	316	2,300	158

Hex Bushing (HB - Male NPT)

Pipe Fitting



(Unit:mm)

Catalog No.	Male Pipe Size	Female Pipe Size	L	d	H width Across flat	Working Pressure(PSIG)			Pressure Rating			
						316SS	Brass	Carbon Steel	SS316 Carbon Steel		Brass	
									psig	bar	psig	bar
FL-HB-0402N	1/4"	1/8"	26.7	7.1	14.2	5600	3100	6200	6,500	447	3,200	220
FL-HB-0602N	3/8"	1/8"	21.8	8.5	17.4				6,500	447	3,200	220
FL-HB-0604N	3/8"	1/4"	30	9.6	19.05	5200	3100	6200	6,600	454	3,300	227
FL-HB-0802N	1/2"	1/8"	27.4	8.5	22.2				6,500	447	3,200	220
FL-HB-0804N	1/2"	1/4"	27.4	11.7	22.2	5800	3100	6200	6,600	454	3,300	227
FL-HB-0806N	1/2"	3/8"	35.6	11.9	22.2	4400	2500	5100	5,300	365	2,600	179
FL-HB-1204N	3/4"	1/4"	27.4	11.4	26.9				6,600	454	3,300	227
FL-HB-1206N	3/4"	3/8"	27.4	15	26.9				5,300	365	2,600	179
FL-HB-1208N	3/4"	1/2"	41.4	15.7	26.9				4,900	337	2,400	165
FL-HB-1604N	1"	1/4"	34.8	11.4	34.9				6,600	454	3,300	227
FL-HB-1608N	1"	1/2"	34.8	18.5	34.9				4,900	337	2,400	165
FL-HB-1612N	1"	3/4"	47	22.4	34.9				4,600	316	2,300	158

Tee (FT) PT

Pipe Fitting

HiFLUX

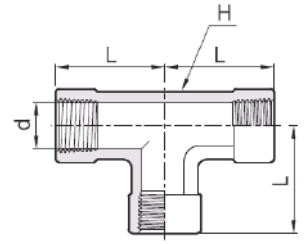

(Unit:mm)

Catalog No.	Pipe Size	L	d	H width Across flat	Pressure Rating			
					SS316 Carbon Steel		Brass	
					psig	bar	psig	bar
P-FT-02R	1/8"	24	8.9	12.7	6,500	447	3,200	220
P-FT-04R	1/4"	29	11.7	17.5	6,600	454	3,300	227
P-FT-06R	3/8"	34.5	15	20.6	5,300	365	2,600	179
P-FT-08R	1/2"	37	18.7	25.4	4,900	337	2,400	165
P-FT-12R	3/4"	46.5	23.5	31.8	4,600	316	2,300	158
P-FT-16R	1"	48.8	29.7	42.9	4,400	303	2,200	151

Tee (FT) NPT

Pipe Fitting

HiFLUX

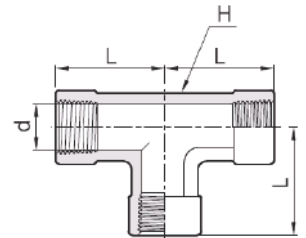

(Unit:mm)

Catalog No.	Pipe Size	L	d	H width Across flat	Pressure Rating			
					SS316 Carbon Steel		Brass	
					psig	bar	psig	bar
P-FT-02N	1/8"	24	8.9	12.7	6,500	447	3,200	220
P-FT-04N	1/4"	29	11.7	17.5	6,600	454	3,300	227
P-FT-06N	3/8"	34.5	15	20.6	5,300	365	2,600	179
P-FT-08N	1/2"	37	18.7	25.4	4,900	337	2,400	165
P-FT-12N	3/4"	46.5	23.5	31.8	4,600	316	2,300	158
P-FT-16N	1"	48.8	29.7	42.9	4,400	303	2,200	151

Elbow (FL) PT

Pipe Fitting

HiFLUX



(Unit:mm)

Catalog No.	Pipe Size	L	d	H width Across flat	Pressure Rating			
					SS316 Carbon Steel		Brass	
					psig	bar	psig	bar
P-FL-02R	1/8"	24	8.9	12.7	6,500	447	3,200	220
P-FL-04R	1/4"	29	11.7	17.5	6,600	454	3,300	227
P-FL-06R	3/8"	34.5	15	20.6	5,300	365	2,600	179
P-FL-08R	1/2"	37	18.7	25.4	4,900	337	2,400	165
P-FL-12R	3/4"	46.5	23.5	31.8	4,600	316	2,300	158
P-FL-16R	1"	48.8	29.7	42.9	4,400	303	2,200	151

Elbow (FL) NPT

Pipe Fitting

HiFLUX



(Unit:mm)

Catalog No.	Pipe Size	L	d	H width Across flat	Pressure Rating			
					SS316 Carbon Steel		Brass	
					psig	bar	psig	bar
P-FL-02N	1/8"	24	8.9	12.7	6,500	447	3,200	220
P-FL-04N	1/4"	29	11.7	17.5	6,600	454	3,300	227
P-FL-06N	3/8"	34.5	15	20.6	5,300	365	2,600	179
P-FL-08N	1/2"	37	18.7	25.4	4,900	337	2,400	165
P-FL-12N	3/4"	46.5	23.5	31.8	4,600	316	2,300	158
P-FL-16N	1"	48.8	29.7	42.9	4,400	303	2,200	151

Cross (FC) PT

Pipe Fitting

HIFLUX

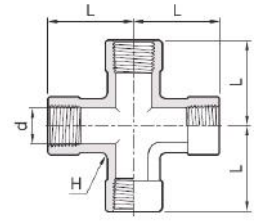

(Unit:mm)

Catalog No.	Pipe Size	L	d	H width Across flat	Pressure Rating			
					SS316 Carbon Steel		Brass	
					psig	bar	psig	bar
P-FC-02R	1/8"	24	8.9	12.7	6,500	447	3,200	220
P-FC-04R	1/4"	29	11.7	17.5	6,600	454	3,300	227
P-FC-06R	3/8"	34.5	15	20.6	5,300	365	2,600	179
P-FC-08R	1/2"	37	18.7	25.4	4,900	337	2,400	165
P-FC-12R	3/4"	46.5	23.5	31.8	4,600	316	2,300	158
P-FC-16R	1"	48.8	29.7	42.9	4,400	303	2,200	151

Cross (FC) NPT

Pipe Fitting

HIFLUX

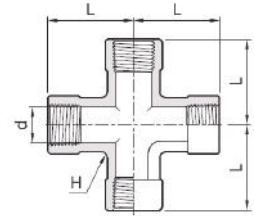

(Unit:mm)

Catalog No.	Pipe Size	L	d	H width Across flat	Pressure Rating			
					SS316 Carbon Steel		Brass	
					psig	bar	psig	bar
P-FC-02N	1/8"	24	8.9	12.7	6,500	447	3,200	220
P-FC-04N	1/4"	29	11.7	17.5	6,600	454	3,300	227
P-FC-06N	3/8"	34.5	15	20.6	5,300	365	2,600	179
P-FC-08N	1/2"	37	18.7	25.4	4,900	337	2,400	165
P-FC-12N	3/4"	46.5	23.5	31.8	4,600	316	2,300	158
P-FC-16N	1"	48.8	29.7	42.9	4,400	303	2,200	151

Branch Tee (BT) PT

Pipe Fitting

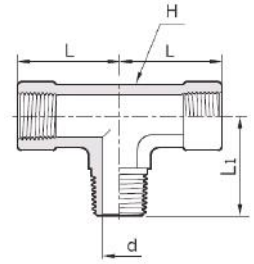

(Unit:mm)

Catalog No.	Pipe Size	L	L1	d	H width Across flat	Pressure Rating			
						SS316 Carbon Steel		Brass	
						psig	bar	psig	bar
FLMBT-02R	1/8"	24	19.6	4.8	12.7	6,500	447	3,200	220
FLMBT-04R	1/4"	29	26.5	7.1	17.5	6,600	454	3,300	227
FLMBT-06R	3/8"	34.5	28.2	9.6	20.6	5,300	365	2,600	179
FLMBT-08R	1/2"	37	35.3	11.9	25.4	4,900	337	2,400	165
FLMBT-12R	3/4"	46.5	39.6	15.7	31.8	4,600	316	2,300	158
FLMBT-16R	1"	48.8	49.2	22.3	42.9	4,400	303	2,200	151

Branch Tee (BT) NPT

Pipe Fitting

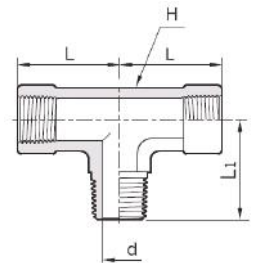

(Unit:mm)

Catalog No.	Pipe Size	L	L1	d	H width Across flat	Pressure Rating			
						SS316 Carbon Steel		Brass	
						psig	bar	psig	bar
FLMBT-02N	1/8"	24	19.6	4.8	12.7	6,500	447	3,200	220
FLMBT-04N	1/4"	29	26.5	7.1	17.5	6,600	454	3,300	227
FLMBT-06N	3/8"	34.5	28.2	9.6	20.6	5,300	365	2,600	179
FLMBT-08N	1/2"	37	35.3	11.9	25.4	4,900	337	2,400	165
FLMBT-12N	3/4"	46.5	39.6	15.7	31.8	4,600	316	2,300	158
FLMBT-16N	1"	48.8	49.2	22.3	42.9	4,400	303	2,200	151

Reducing Adapter (ADR - Male PT)

Pipe Fitting

HiFLUX

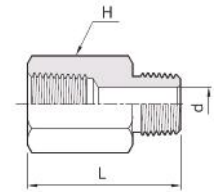

(Unit:mm)

Catalog No.	Male Thread Size	Female Thread Size	L	d	H Hex	Pressure Rating			
						SS316 Carbon Steel		Brass	
						psig	bar	psig	bar
FL-ADR-0204R	1/8"	1/4"	31.5	4.8	19.05	6,600	454	3,300	227
FL-ADR-0206R	1/8"	3/8"	33.5	4.8	22.2	5,300	365	2,600	179
FL-ADR-0406R	1/4"	3/8"	37.8	7.1	22.2	5,300	365	2,600	179
FL-ADR-0208R	1/8"	1/2"	40	4.8	26.9	4,900	337	2,400	165
FL-ADR-0408R	1/4"	1/2"	44.5	7.1	26.9	4,900	337	2,400	165
FL-ADR-0608R	3/8"	1/2"	44.5	9.6	26.9	4,900	337	2,400	165
FL-ADR-0412R	1/4"	3/4"	45.7	7.1	31.8	4,600	316	2,300	158
FL-ADR-0612R	3/8"	3/4"	45.7	9.6	31.8	4,600	316	2,300	158
FL-ADR-0812R	1/2"	3/4"	51.1	11.9	31.8	4,600	316	2,300	158
FL-ADR-0416R	1/4"	1"	50.8	7.1	41.2	4,400	303	2,200	151
FL-ADR-0816R	1/2"	1"	55.3	11.9	41.2	4,400	303	2,200	151
FL-ADR-1216R	3/4"	1"	54.9	15.7	41.2	4,400	303	2,200	151

Reducing Adapter (ADR - Male NPT)

Pipe Fitting

HiFLUX

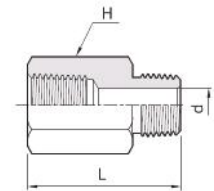

(Unit:mm)

Catalog No.	Male Thread Size	Female Thread Size	L	d	H Hex	Pressure Rating			
						SS316 Carbon Steel		Brass	
						psig	bar	psig	bar
FL-ADR-0204N	1/8"	1/4"	31.5	4.8	19.05	6,600	454	3,300	227
FL-ADR-0206N	1/8"	3/8"	33.5	4.8	22.2	5,300	365	2,600	179
FL-ADR-0406N	1/4"	3/8"	37.8	7.1	22.2	5,300	365	2,600	179
FL-ADR-0208N	1/8"	1/2"	40	4.8	26.9	4,900	337	2,400	165
FL-ADR-0408N	1/4"	1/2"	44.5	7.1	26.9	4,900	337	2,400	165
FL-ADR-0608N	3/8"	1/2"	44.5	9.6	26.9	4,900	337	2,400	165
FL-ADR-0412N	1/4"	3/4"	45.7	7.1	31.8	4,600	316	2,300	158
FL-ADR-0612N	3/8"	3/4"	45.7	9.6	31.8	4,600	316	2,300	158
FL-ADR-0812N	1/2"	3/4"	51.1	11.9	31.8	4,600	316	2,300	158
FL-ADR-0416N	1/4"	1"	50.8	7.1	41.2	4,400	303	2,200	151
FL-ADR-0816N	1/2"	1"	55.3	11.9	41.2	4,400	303	2,200	151
FL-ADR-1216N	3/4"	1"	54.9	15.7	41.2	4,400	303	2,200	151

Adapter (ADR - Male PT)

Pipe Fitting

HiFLUX

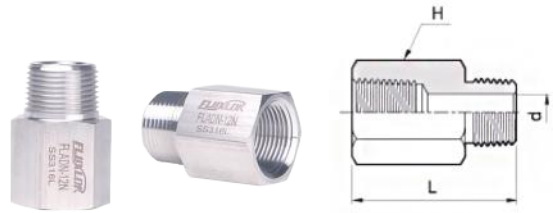

(Unit:mm)

Catalog No.	Pipe Size	L	d	H width Across flat	Pressure Rating			
					SS316 Carbon Steel		Brass	
					psig	bar	psig	bar
FL-ADR-02R	1/8"	27.4	4.8	14.2	6,500	447	3,200	220
FL-ADR-04R	1/4"	35.6	7.1	19.05	6,600	454	3,300	227
FL-ADR-06R	3/8"	37.8	9.6	22.2	5,300	365	2,600	179
FL-ADR-08R	1/2"	49	11.9	26.9	4,900	337	2,400	165
FL-ADR-12R	3/4"	50.3	15.7	31.7	4,600	316	2,300	158
FL-ADR-16R	1"	58	22.3	41.2	4,400	303	2,200	151

Adapter (ADN - Male NPT)

Pipe Fitting

HiFLUX

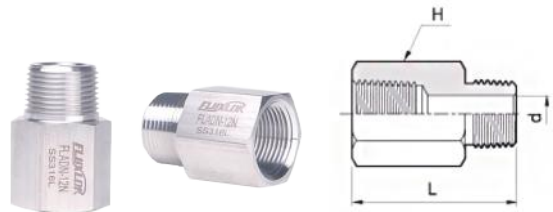

(Unit:mm)

Catalog No.	Pipe Size	L	d	H width Across flat	Pressure Rating			
					SS316 Carbon Steel		Brass	
					psig	bar	psig	bar
FL-ADN-02N	1/8"	27.4	4.8	14.2	6,500	447	3,200	220
FL-ADN-04N	1/4"	35.6	7.1	19.05	6,600	454	3,300	227
FL-ADN-06N	3/8"	37.8	9.6	22.2	5,300	365	2,600	179
FL-ADN-08N	1/2"	49	11.9	26.9	4,900	337	2,400	165
FL-ADN-12N	3/4"	50.3	15.7	31.7	4,600	316	2,300	158
FL-ADN-16N	1"	58	22.3	41.2	4,400	303	2,200	151

Adapter (ADRN)

Pipe Fitting

HiFLUX



(Unit:mm)

Catalog No.	NPT Thread Size	BSPT/ISO Thread Size	L	Ø	d	H Hex	Pressure Rating			
							SS316 Carbon Steel		Brass	
							psig	bar	psig	bar
P-ADRN-02R02N	1/8"	1/8-28 7/1	27.4	9.7	4.8	14.2	6,500	447	3,200	220
P-ADRN-04R04N	1/4"	1/4-19 7/1	35.8	14.2	7.1	19.05	6,600	454	3,300	227
P-ADRN-06R06N	3/8"	3/8-19 7/1	37.6	14.2	9.7	22.2	5,300	365	2,600	179
P-ADRN-08R08N	1/2"	1/2-14 7/1	49	19.1	11.9	26.9	4,900	337	2,400	165
P-ADRN-12R12N	3/4"	3/4-14 7/1	50.3	19.1	15.7	31.8	4,600	316	2,300	158
P-ADRN-16R16N	1"	1-11 7/1	58	23.9	22.3	41.2	4,400	303	2,200	151

Adapter (ADGN)

Pipe Fitting

HiFLUX



(Unit:mm)

Catalog No.	NPT Thread Size	BSPT/ISO Thread Size	L	Ø	C	d	H Hex	Pressure Rating			
								SS316 Carbon Steel		Brass	
								psig	bar	psig	bar
P-ADGN-02G02N	1/8"	1/8-28 228/1	24.9	7.1	13.7	4.1	14.2	6,500	447	3,200	220
P-ADGN-04G04N	1/4"	1/4-19 228/1	33.3	11.2	17.8	5.8	19.05	6,600	454	3,300	227
P-ADGN-06G06N	3/8"	3/8-19 228/1	37.8	11.2	21.8	7.9	22.2	5,300	365	2,600	179
P-ADGN-08G08N	1/2"	1/2-14 228/1	43.9	14.2	26.1	11.9	26.9	4,900	337	2,400	165
P-ADGN-12G12N	3/4"	3/4-14 228/1	50.8	15.7	31.5	15.7	33.3	4,600	316	2,300	158
P-ADGN-16G16N	1"	1-11 228/1	53.1	18.3	38.9	19.8	41.2	4,400	303	2,200	151

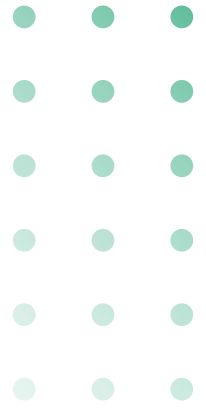

VCR Fitting

Perfect Connection, Solid Trust

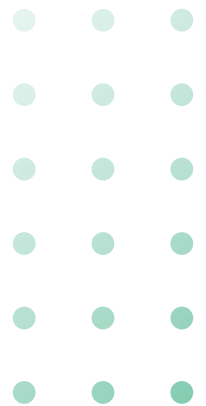

Gland (Short Socket Weld)

Metal Seal Fitting

HIFLUX

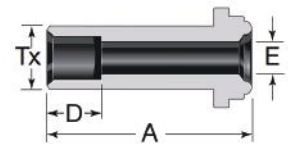

(Unit:mm)

Catalog No.	Tube Size	VCR Size	Dimensions				Working Pressure		
			A	D	E	Tx	Ni	SS	Cu
SS-4-VCR-3-.50LG	1/4"	1/4"	0.50 inch (12.7 mm)	0.28 inch (7.1 mm)	0.18 inch (4.6 mm)	0.35 inch (8.9 mm)	5,500 psig (378 bar)	5,500 psig (378 bar)	5,500 psig (378 bar)
SS-4-VCR-3-.75LG			0.75 inch (19.1 mm)						

Plug

Metal Seal Fitting

HIFLUX

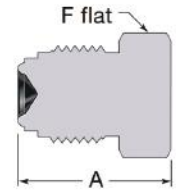

(Unit:mm)

Catalog No.	VCR Size	Dimensions	
		A	F
SS-2-VCR-P	1/8"	0.68 inch (17.3 mm)	3/8"
SS-4-VCR-P	1/4"	0.92 inch (23.4 mm)	5/8"
SS-8-VCR-P	1/2"	1.08 inch (27.4 mm)	15/16"
SS-12-VCR-P	3/4"	1.43 inch (36.3 mm)	1-5/16"
SS-16-VCR-P	1"	1.52 inch (38.6 mm)	1-5/8"

Male Nut

Metal Seal Fitting

HIFLUX

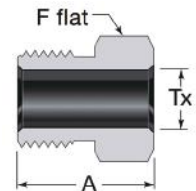

(Unit:mm)

Catalog No.	VCR Size	Dimensions		
		A	F	Tx
SS-2-VCR-4	1/8"	0.50 inch (12.7 mm)	3/8"	0.21 inch (5.3 mm)
SS-4-VCR-4	1/4"	0.71 inch (18.0 mm)	5/8"	0.21 inch (5.3 mm)
SS-8-VCR-4	1/2"	0.81 inch (20.6 mm)	15/16"	0.61 inch (15.5 mm)
SS-12-VCR-4	3/4"	1.00 inch (25.4 mm)	1-5/16"	0.89 inch (22.6 mm)

Female Nut

Metal Seal Fitting

HIFLUX

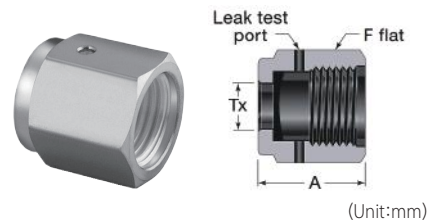

(Unit:mm)

Catalog No.	VCR Size	Dimensions		
		A	F	Tx
SS-02-VCR-1	1/8"	0.53 inch (13.5 mm)	7/16"	0.21 inch (5.3 mm)
SS-04-VCR-1	1/4"	0.81 inch (20.6 mm)	3/4"	0.36 inch (9.1 mm)
SS-08-VCR-1	1/2"	0.88 inch (22.4 mm)	1-1/16"	0.61 inch (15.5 mm)
SS-12-VCR-1	3/4"	1.12 inch (28.4 mm)	1-1/2"	0.89 inch (22.6 mm)

Gland (Male Weld)

Metal Seal Fitting

HIFLUX

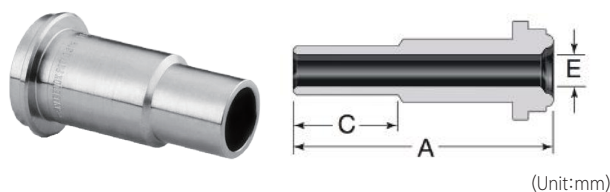

(Unit:mm)

Catalog No.	Tube Size	VCR Size	Dimensions			Working Pressure		
			A	C	E	Ni	SS	Cu
SS-2-VCR-3-2MTW	1/8"	1/8"	0.07 inch (17.8 mm)	0.28 inch (7.1 mm)	0.06 inch (1.5 mm)	9,000 psig (620 bar)	11,200 psig (771 bar)	7,200 psig (496 bar)
SS-4-VCR-3-2MTW		1/4"	1.31 inch (33.3 mm)			8,000 psig (551 bar)	10,000 psig (689 bar)	6,400 psig (440 bar)
SS-4-VCR-3-4MTW	1/4"	1/4"	1.31 inch (33.3 mm)	0.41 inch (10.4 mm)	0.12 inch (3.0 mm)	8,000 psig (551 bar)	10,000 psig (689 bar)	6,400 psig (440 bar)
SS-8-VCR-3-4MTW		1/2"	1.50 inch (38.1 mm)			3,500 psig (241 bar)	4,300 psig (296 bar)	2,800 psig (192 bar)
SS-8-VCR-3-6MTW	3/8"	1/2"	1.50 inch (38.1 mm)	0.41 inch (10.4 mm)	0.28 inch (7.1 mm)	3,500 psig (241 bar)	4,300 psig (296 bar)	2,800 psig (192 bar)
SS-8-VCR-3-8MTW	1/2"	1/2"	1.50 inch (38.1 mm)	0.50 inch (12.7 mm)	0.40 inch (10.2 mm)	3,500 psig (241 bar)	3,500 psig (241 bar)	2,800 psig (192 bar)
SS-12-VCR-3-12MTW	3/4"	3/4"	2.00 inch (50.8 mm)	0.62 inch (15.7 mm)	0.53 inch (13.5 mm)	3,000 psig (206 bar)	3,700 psig (254 bar)	2,400 psig (165 bar)

Male Connector NPT

Metal Seal Fitting

HiFLUX

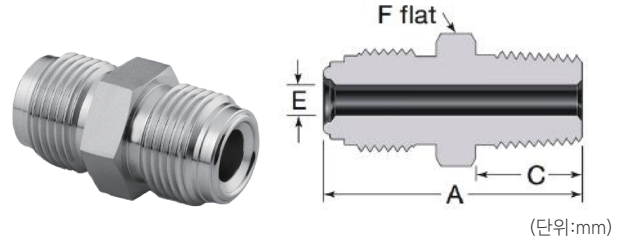

(단위:mm)

Catalog No.	NPT Size	VCR Size	Dimensions				Working Pressure		
			A	C	E	F	Ni	SS	Cu
SS-2-VCR-1-2	1/8"	1/8"	1.07 inch (27.2 mm)	0.38 inch (9.6 mm)	0.09 inch (2.3 mm)	7/16"	9,000 psig (620 bar)	9,000 psig (620 bar)	7,200 psig (496 bar)
SS-4-VCR-1-2		1/4"	1.31 inch (33.3 mm)		0.18 inch (4.6 mm)	5/8"	8,000 psig (551 bar)	10,000 psig (689 bar)	6,400 psig (440 bar)
SS-4-VCR-1-4	1/4"	1/4"	1.49 inch (37.8 mm)	0.56 inch (14.2 mm)	0.18 inch (4.6 mm)	5/8"	8,000 psig (551 bar)	10,000 psig (689 bar)	6,400 psig (440 bar)
SS-8-VCR-1-4		1/2"	1.65 inch (41.9 mm)		0.28 inch (7.1 mm)	15/16"	3,500 psig (241 bar)	4,300 psig (296 bar)	2,800 psig (192 bar)
SS-8-VCR-1-8	1/2"	1/2"	1.84 inch (46.7 mm)	0.75 inch (19.1 mm)	0.40 inch (10.2 mm)	15/16"	3,500 psig (241 bar)	4,300 psig (296 bar)	2,800 psig (192 bar)
SS-12-VCR-1-12	3/4"	3/4"	2.19 inch (55.6 mm)	0.75 inch (19.1 mm)	0.62 inch (15.7 mm)	1-5/16"	3,000 psig (206 bar)	3,700 psig (254 bar)	2,400 psig (165 bar)

Tube Fitting Connector

Metal Seal Fitting

HiFLUX

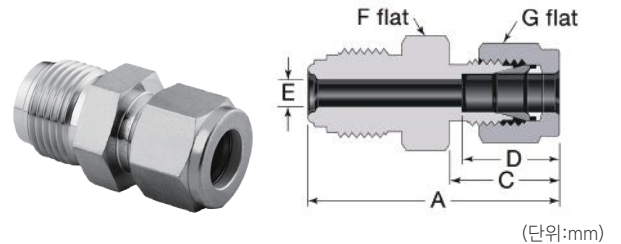

(단위:mm)

Catalog No.	Tube Size	VCR Size	Dimensions					
			A	C	D	E	F	G
FLSS-8-VCR-6-400	1/4"	1/2"	45.3 mm	17.8mm	15.2 mm	10.2 mm	5/8"	7/8"

Cap

Metal Seal Fitting

HiFLUX

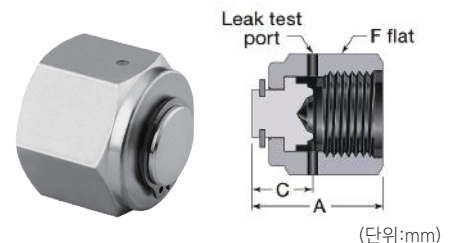

(단위:mm)

Catalog No.	VCR Size	Dimensions		
		A	C	F
SS-2-VCR-CP	1/8"	0.63 inch (16.0 mm)	0.30 inch (7.6 mm)	7/16
SS-4-VCR-CP	1/4"	0.94 inch (23.9 mm)	0.44 inch (11.2 mm)	3/4
SS-8-VCR-CP	1/2"	1.01 inch (25.6 mm)	0.45 inch (11.4 mm)	1-1/16
SS-12-VCR-CP	3/4"	1.29 inch (32.8 mm)	0.54 inch (13.7 mm)	1-1/2



(주) 하이플럭스

Home_hiflux.com / Shop_www.hifluxmall.com

(34037) 대전광역시 유성구 갑천로 361-23 (탑립동 933-7) TEL. 042-933-5670 FAX. 0303-0799-1241
361-23, Capcheon-ro, Yuseong-gu, Daejeon, 34037, Republic of Korea TEL. +82-42-933-5670 FAX. +82-0303-0799-1241